

TYEE HIGH SCHOOL REPLACEMENT FRONTAGE IMPROVEMENTS

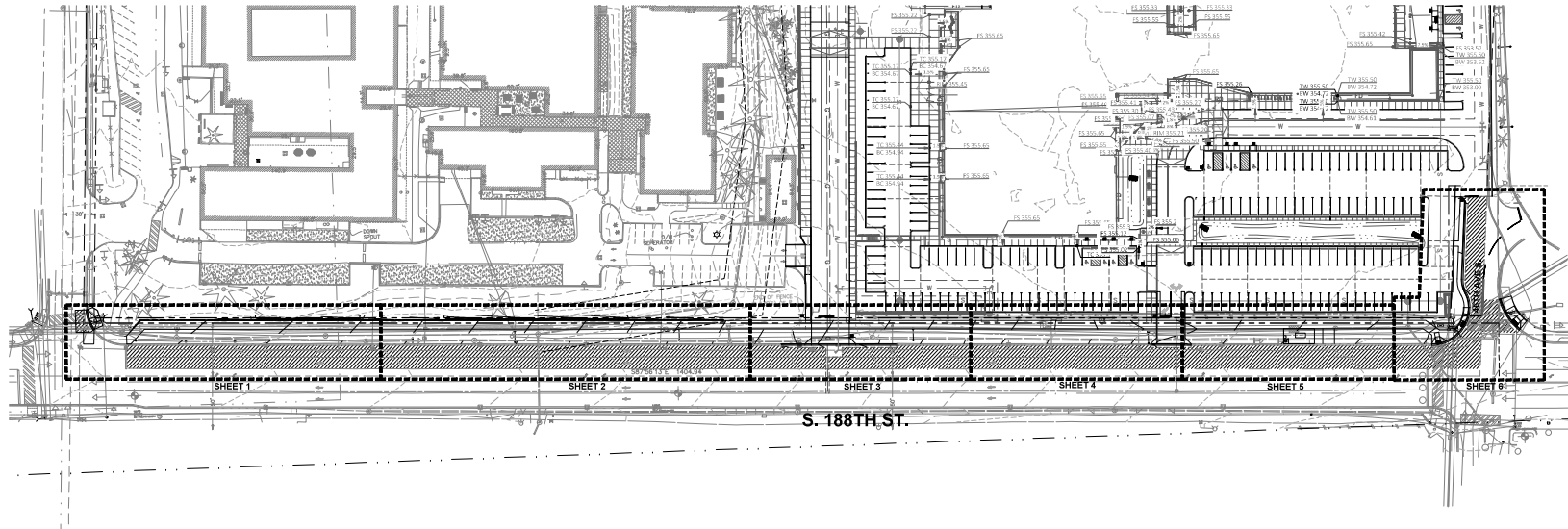

S. 188TH ST.

KEY MAP
SCALE 1"=20'

EXISTING LEGEND:

▲ SET NAIL AND WASHER FOUND MONUMENT AS NOTED	● HUB AND TACK	● SET REBAR AND CAP	● BOLLARD	□ M&B BOX	□ SIGN	○ SANITARY SEWER IMHOLE	○ SANITARY SEWER CLEANOUT	□ STORM CATCH BASIN	○ STORM MANHOLE	○ ROOF DRAIN	□ GAS METER	□ GAS VALVE	□ TRAFFIC SIGNAL POLE	□ TRAFFIC CABINET	□ POWER TRANSFORMER	□ GUY ANCHOR	□ UTILITY POWER POLE	□ ELECTRICAL VAULT	□ JUNCTION BOX	□ POWER METER	□ LUMINAIRE	□ TELEPHONE RISER	□ TELEPHONE VAULT	▽ FIRE DEPARTMENT CONNECTION	△ FIRE HYDRANT	□ IRRIGATION CONTROL VALVE	□ ROSE BEE	□ WATER METER	□ WATER VALVE	○ AMARBLE BUBBICH FIRN, PINE, HEMLOCK	○ HO-HOLLY, MAPLE, CHOK-LU-LINDEN	- - - D - - - STORM LINE	- - - S - - - SANITARY SEWER LINE	- - - G - - - GAS LINE	- - - P - - - ELECTRICAL LINE	- - - T - - - COMMUNICATIONS LINE	- - - W - - - WATER LINE	- - - IR - - - IRRIGATION PER RECORD DRAWING	- - - OUP - - - OVERHEAD UTILITY	- - - STEAM LINE	▬ FENCE	▬ CONCRETE	▬ ASPHALT	- - - CONTOUR MAJOR INTERVAL	- - - CONTOUR MINOR INTERVAL	- - - PROPERTY / RIGHT-OF-WAY LINE
---	----------------	---------------------	-----------	-----------	--------	-------------------------	---------------------------	---------------------	-----------------	--------------	-------------	-------------	-----------------------	-------------------	---------------------	--------------	----------------------	--------------------	----------------	---------------	-------------	-------------------	-------------------	------------------------------	----------------	----------------------------	------------	---------------	---------------	---------------------------------------	-----------------------------------	--------------------------	-----------------------------------	------------------------	-------------------------------	-----------------------------------	--------------------------	--	----------------------------------	------------------	---------	------------	-----------	------------------------------	------------------------------	------------------------------------

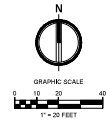

Date:	04/20/23	
Job No.:	130265-03	
Drawn By:	CTJ	
Checked By:	GGT	
Revised:		
1	Date	Description

FRONTAGE KEY
MAP

C10.00

**HIGHLINE PUBLIC SCHOOLS
TYEE HIGH SCHOOL REPLACEMENT PROJECT**

4424 S 188th St
Seattle, WA 98188



Date	04/20/23	
Job No.	210295.00	
Drawn By	CTJ	
Checked By	DSJ	
Revision		
1	Date	Descriptor

FRONTAGE
IMPROVEMENT
PLAN

C10.01

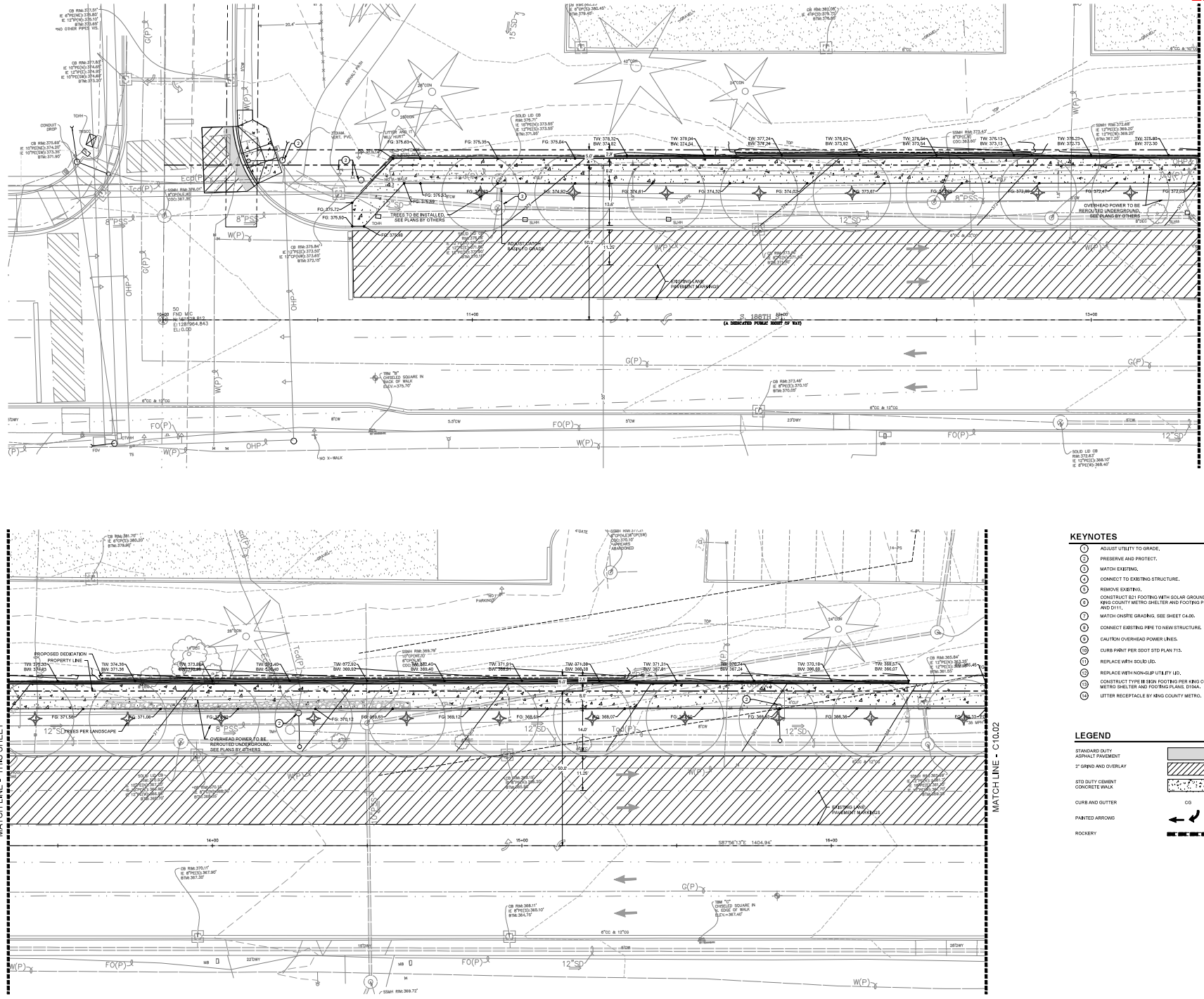

- KEYNOTES**
- ① ADJUST UTILITY TO GRADE, PRESERVE AND PROTECT.
 - ② MATCH EXISTING.
 - ③ CONNECT TO EXISTING STRUCTURE.
 - ④ REMOVE EXISTING.
 - ⑤ CONSTRUCT 6:1 FOOTING WITH SOLAR GROUNDING PER KING COUNTY METRO SHELTER AND FOOTING PLANS, 0104 AND 0111.
 - ⑥ MATCH ON-GRADE GRADING. SEE SHEET CALD.
 - ⑦ CONNECT EXISTING PIPE TO NEW STRUCTURE.
 - ⑧ CAUTION OVERHEAD POWER LINES.
 - ⑨ REPLACE WITH SOLID LID.
 - ⑩ REPLACE WITH NON-SLIP UTILITY LID.
 - ⑪ CONSTRUCT TYPE B SLOPE FOOTING PER KING COUNTY METRO SHELTER AND FOOTING PLANS, 0104 AND 0111.
 - ⑫ LITTER RECEPTACLE BY KING COUNTY METRO.

- LEGEND**
- STANDARD DUTY ASPHALT PAVEMENT
 - 2" GRIND AND OVERLAY
 - STD DUTY CEMENT CONCRETE WALK
 - CURBS AND UTILITY
 - PAINTED ARROWS
 - ROCKERY

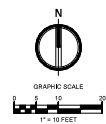



Date	04/26/23
Job No.	2102056-03
Drawn By	CTJ
Checked By	DDT
Revised	
1 Date	Description

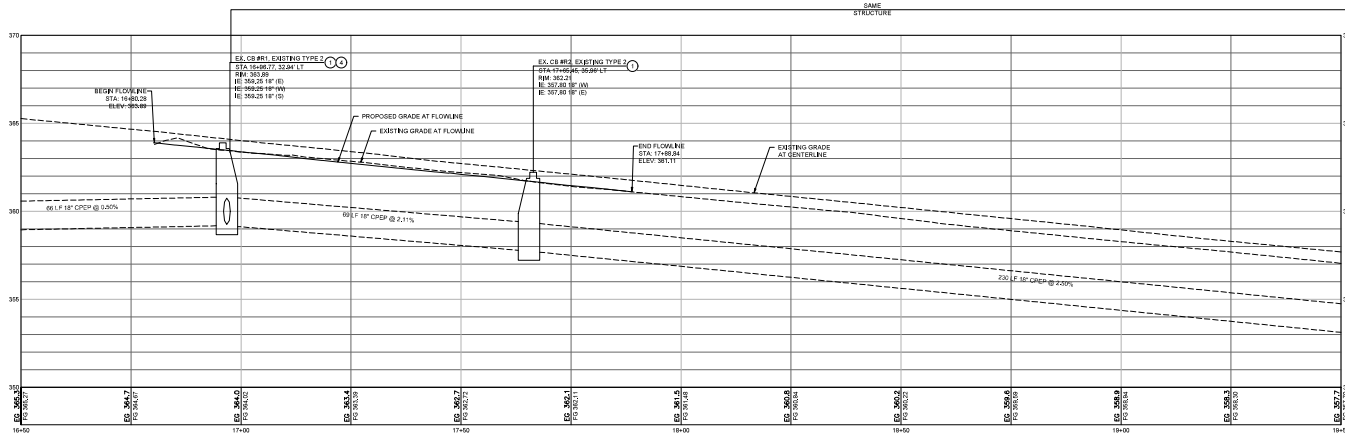

S. 188TH ST. PROFILE
SCALE: 1" = 10' (HORIZ)
1" = 4' (VERT)

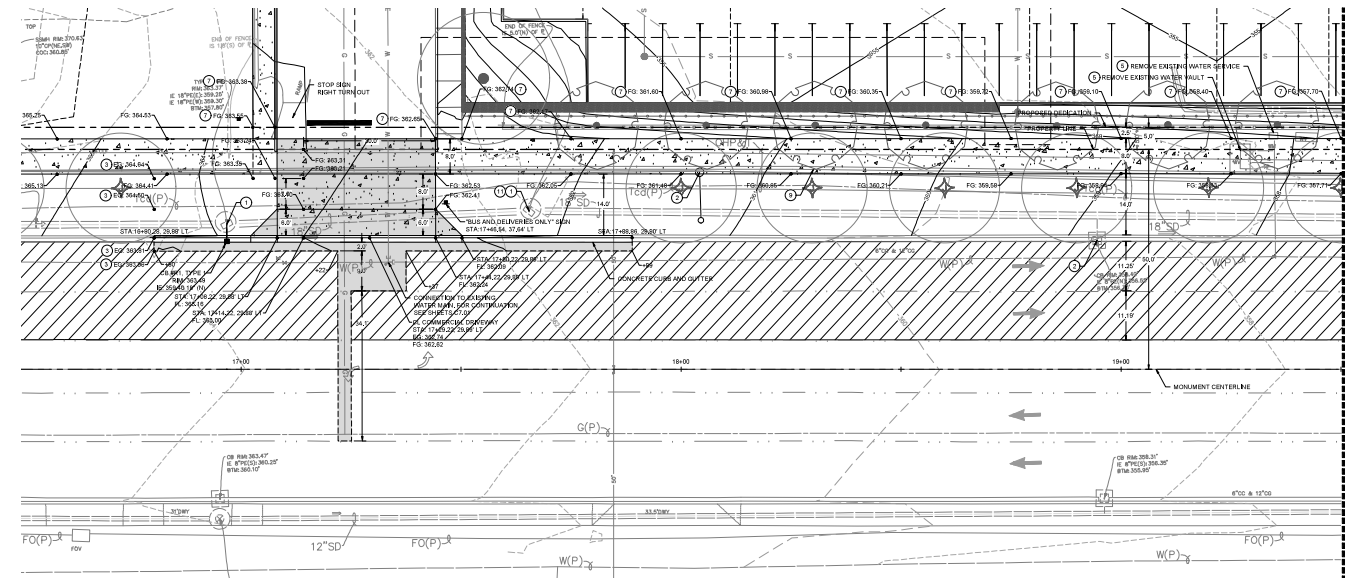
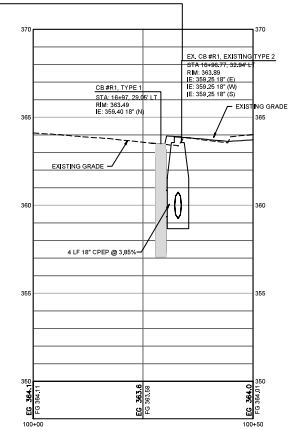

S. 188TH ST. PLAN
SCALE: 1" = 10'

KEYNOTES

- 1. ADJUST UTILITY TO GRADE.
- 2. PRESERVE AND PROTECT.
- 3. MATCH EXISTING.
- 4. CONNECT TO EXISTING STRUCTURE.
- 5. REMOVE EXISTING.
- 6. CONSTRUCT 821 FOOTING WITH SOLAR GRADING PER KING COUNTY METRO SHELTER AND FOOTING PLANS, D103 AND D111.
- 7. MATCH ON-SITE GRADING, SEE SHEET C4.00.
- 8. CONNECT EXISTING PIPE TO NEW STRUCTURE.
- 9. CAUTION OVERHEAD POWER LINES.
- 10. CURB PAINT PER SDD STD PLAN 715.
- 11. REPLACE WITH SOLID IUD.
- 12. REPLACE WITH NON-SLIP UTILITY IUD.
- 13. CONSTRUCT TYEE BEB FOOTING PER KING COUNTY METRO SHELTER AND FOOTING PLANS, DISA.
- 14. UTILITY RECEPTACLE BY KING COUNTY METRO.

MATCH LINE - THIS SHEET



Date	04/26/23	
Job No.	210205-03	
Drawn By	CTJ	
Checked By	BCJ	
Revised		
1	Date	Descriptor

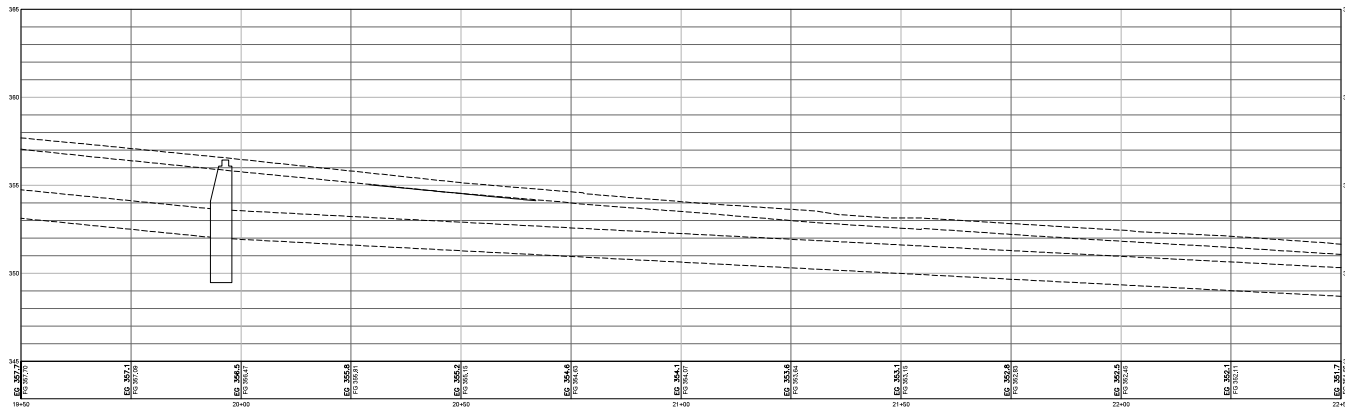

S. 188TH ST. PROFILE
SCALE: 1" = 10' (HORIZ)
1" = 4' (VERT)

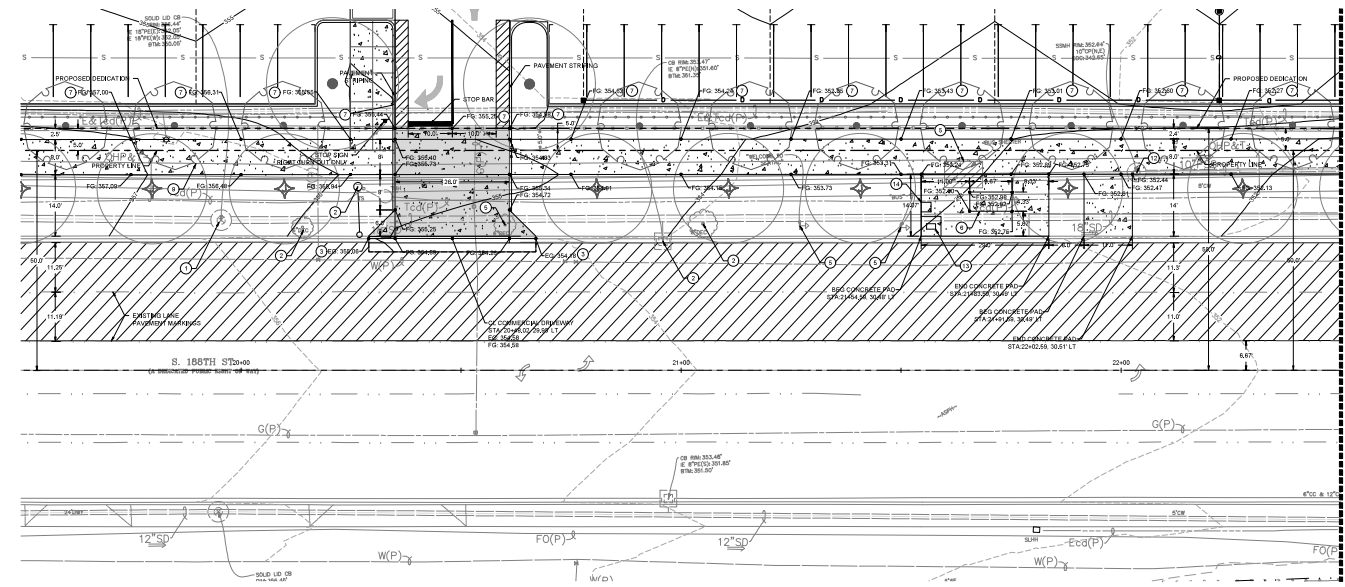

S. 188TH ST. PLAN
SCALE: 1" = 10'

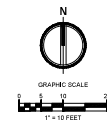

KEYNOTES

- 1. ADJUST UTILITY TO GRADE.
- 2. PRESERVE AND PROTECT.
- 3. MATCH EXISTING.
- 4. CONNECT TO EXISTING STRUCTURE.
- 5. REMOVE EXISTING.
- 6. CONSTRUCT 801 FOOTINGS WITH SOLAR GROUNDING PER KING COUNTY METRO SHELTER AND FOOTING PLANS, D103 AND D111.
- 7. MATCH ON-SITE GRADING, SEE SHEET C4.00.
- 8. CONNECT EXISTING PPE TO NEW STRUCTURE.
- 9. CAUTION OVERHEAD POWER LINES.
- 10. CURB PAINT PER SDD STD PLAN 715.
- 11. REPLACE METH SOLID ILS.
- 12. REPLACE METH NON-SLIP UTILITY ILS.
- 13. CONSTRUCT TYPE B BENCH FOOTING PER KING COUNTY METRO SHELTER AND FOOTING PLANS, D104A.
- 14. LETTER RECEPTACLE BY KING COUNTY METRO.

KING COUNTY METRO NOTES

1. ALL CONSTRUCTION AND OTHER SUBMITTAL ACTIVITY AFFECTING KING COUNTY METRO TRANSIT OPERATIONS OR FACILITIES MUST BE COORDINATED THROUGH THE RCN SYSTEM MANAGER'S WORKGROUP. PLEASE CONTACT THEM TO PROVIDE SPECIFIC INFORMATION RELATED TO THE ACTIVITY AND ALLOW THE REQUIRED LEAD TIME NECESSARY FOR PERFORMING TO ANY IMPACTS CAUSED BY IT. FOR EXTRA INFORMATION AND SUBMITTALS PLEASE VISIT [HTTP://KINGCOUNTY.GOV/TRANSPORTATION/030/METRO/TRANSIT-CONSTRUCTION](http://kingcounty.gov/transportation/030/metro/transit-construction) (CONTRACTORS/TRANSIT SYSTEM IMPACTS.ASPX OR PHONE 206.477.1340).
2. PRIOR TO CONSTRUCTION OF METRO FOOTINGS AND FACILITIES, PLEASE CONTACT METRO INSPECTOR AND CONSTRUCTION AT BUSSTOPRECONSTRUCTION@KINGCOUNTY.GOV OR BY PHONE AT 206.248-2381. PLEASE NOTE THAT METRO REQUIRES NOTICE OF AT LEAST THREE WEEKS IN ADVANCE TO SCHEDULE AN INSPECTOR. ALL METRO FOOTINGS MUST BE INSPECTED AND APPROVED BY METRO INSPECTORS BEFORE ANY CONCRETE IS POURED.
3. TO SCHEDULE SHELTER REMOVAL, PLEASE CONTACT A ASHIEVE@KINGCOUNTY.GOV. PLEASE NOTE THAT METRO REQUIRES 3 WEEKS PRIOR NOTIFICATION FOR REMOVAL.
4. PLEASE SEE THE FOLLOWING URL FOR STANDARD CONSTRUCTION DETAILS: [HTTP://KINGCOUNTY.GOV/DEPTS/TRANSPORTATION/METRO/ABOUT/CONSTRUCTION-CONTRACTORS/CAPITAL-PLAN.ASPX](http://kingcounty.gov/depts/transportation/metro/about/construction-contractors/capital-plan.aspx)
5. PER SECTION 810 OF THE ADA STANDARDS FOR TRANSPORTATION FACILITIES, THE CROSS-SLOPE OF A BUS STOP BOARDING AND ALIGHTING AREA SHALL NOT BE STEEPER THAN 1:48 (2%). THIS STANDARD APPLIES TO ANY NEW OR MODIFIED BUS STOP.

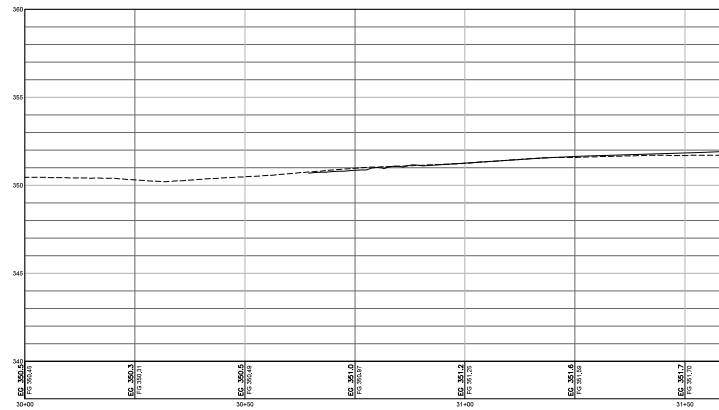
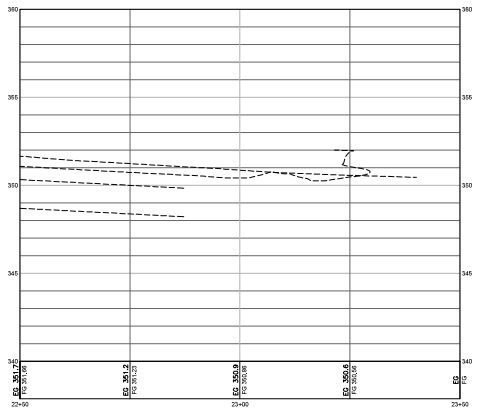

S. 188TH ST. PROFILE
SCALE: 1" = 10' (HORIZ)
1" = 4' (VERT)

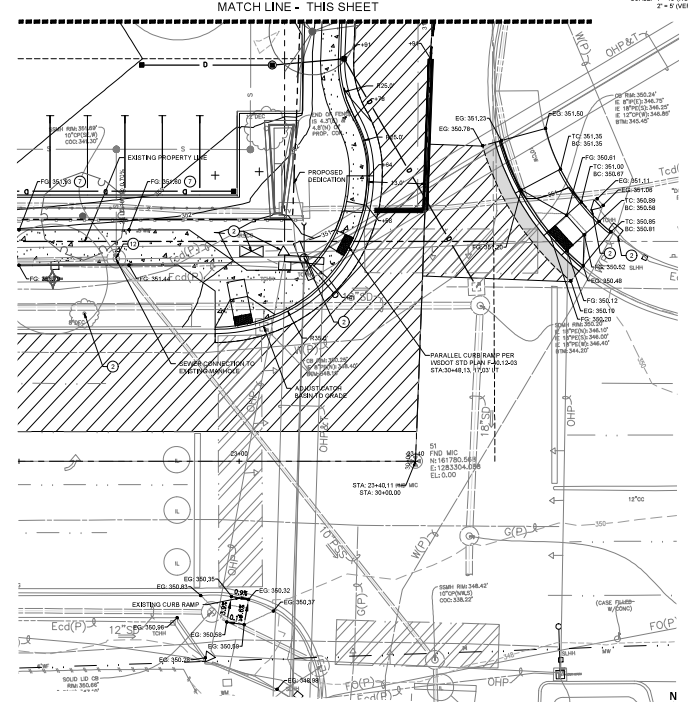

S. 188TH ST. PLAN
SCALE: 1" = 10'

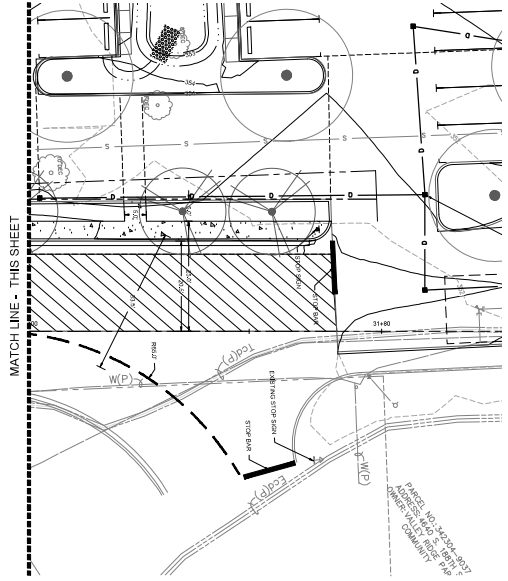

S. 188TH ST. PLAN
SCALE: 1" = 10'

- KEYNOTES**
- ① ADJUST UTILITY TO GRADE.
 - ② PRESERVE AND PROTECT.
 - ③ MATCH EXISTING.
 - ④ CONNECT TO EXISTING STRUCTURE.
 - ⑤ REMOVE EXISTING.
 - ⑥ CONSTRUCT 80" FOOTING WITH SOLAR GROUNDING PER KING COUNTY METRO SHELTER AND FOOTING PLANS, DISA AND DISA-1.
 - ⑦ MATCH ON SITE GRADING, SEE SHEET CA-00.
 - ⑧ CONNECT EXISTING PIPE TO NEW STRUCTURE.
 - ⑨ CAUTION OVERHEAD POWER LINES.
 - ⑩ CURB PAINT PER SDOT STD PLAN 715.
 - ⑪ REPLACE WITH SOLID ILS.
 - ⑫ REPLACE WITH NON-SLIP UTILITY ILS.
 - ⑬ CONSTRUCT TYPE B BIER FOOTING PER KING COUNTY METRO SHELTER AND FOOTING PLANS, DISA.
 - ⑭ LETTER RECEIPTABLE BY KING COUNTY METRO.

**HIGHLINE PUBLIC SCHOOLS
TYEE HIGH SCHOOL REPLACEMENT PROJECT**



Date: 04/26/23
Job No.: 2102050-03
Drawn By: CTJ
Checked By: GDT
Revised: 1 Date: Description

FRONTAGE IMPROVEMENT PLAN AND PROFILE

C10.03