

City of SeaTac

Planning Commission

January 17, 2017



S. 154th Station Area Overlay
District – Planning Commission
Recommendation for Building
Setback/Orientation

Existing Conditions - Sidewalks

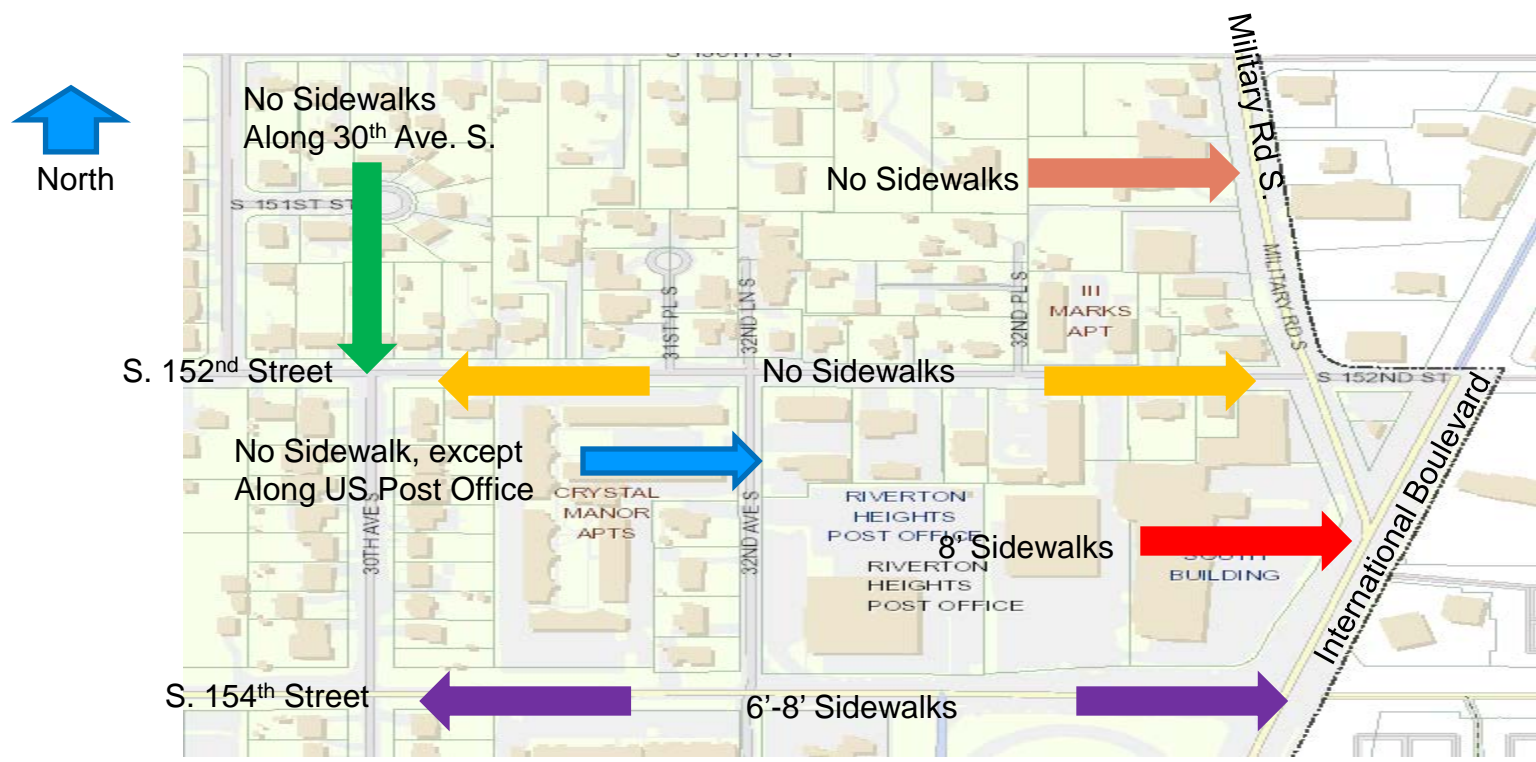

International Boulevard (S. 154th Street to S. 152nd Street)

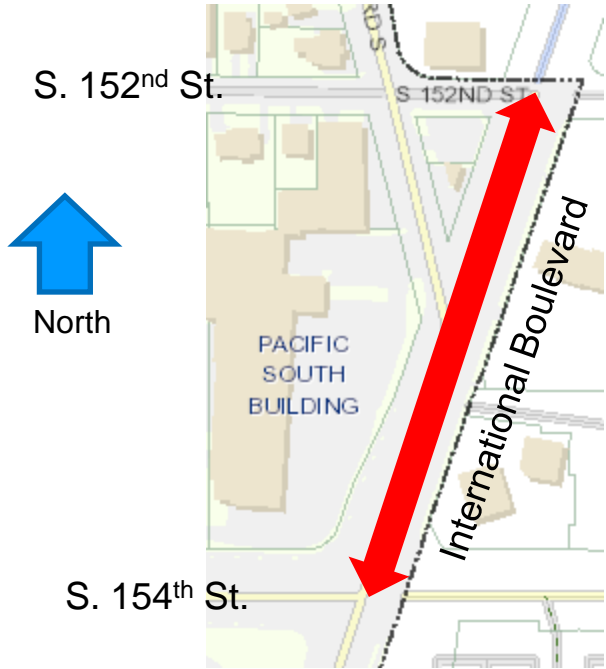

Existing Conditions: 8' sidewalks with street trees west and east side of streets within 100' ROW

Urban Design Recommendation

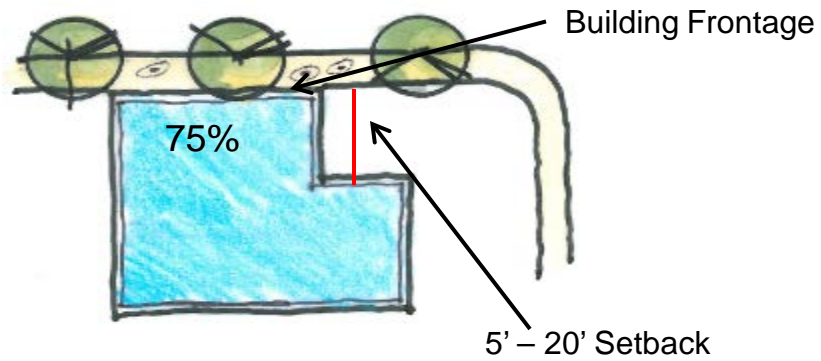
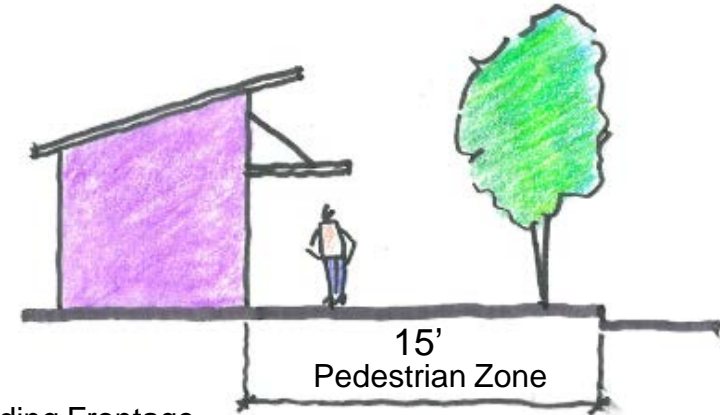
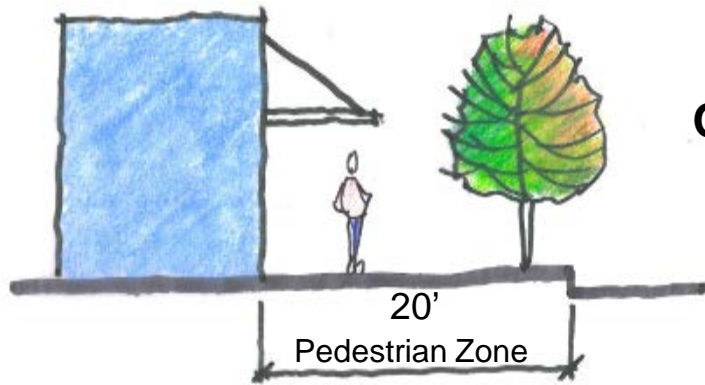

Option B

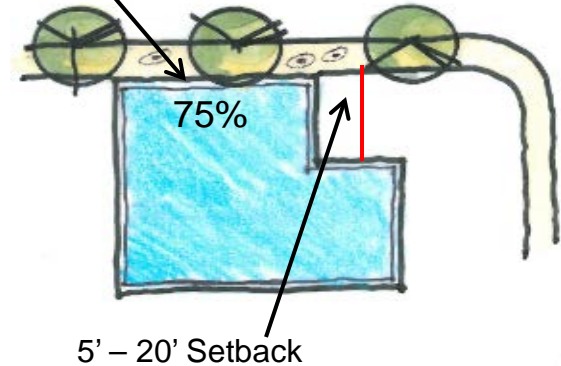

Military Road South (S. 152nd Street to S. 150th Street)

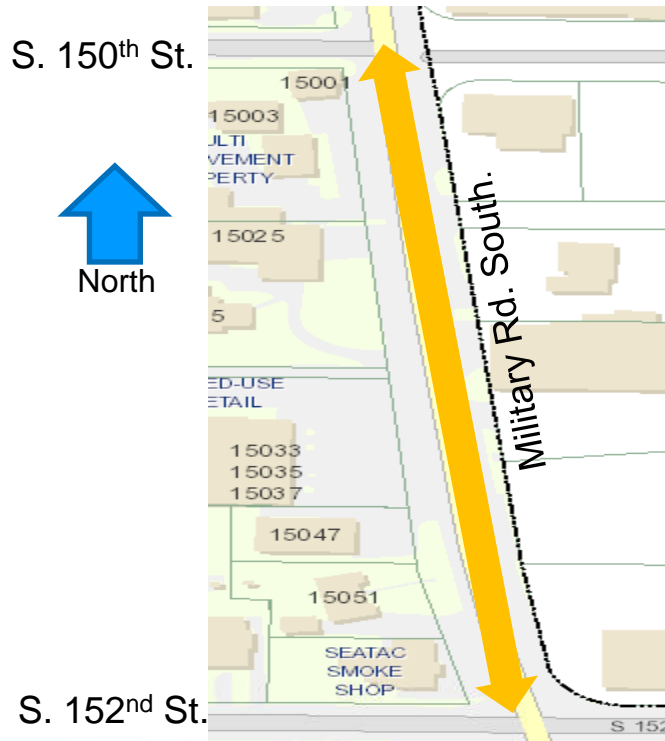

Existing Conditions: No sidewalks;
60' of ROW

S. 154th St Station Area Action Plan

Military Rd. S. Recommendation

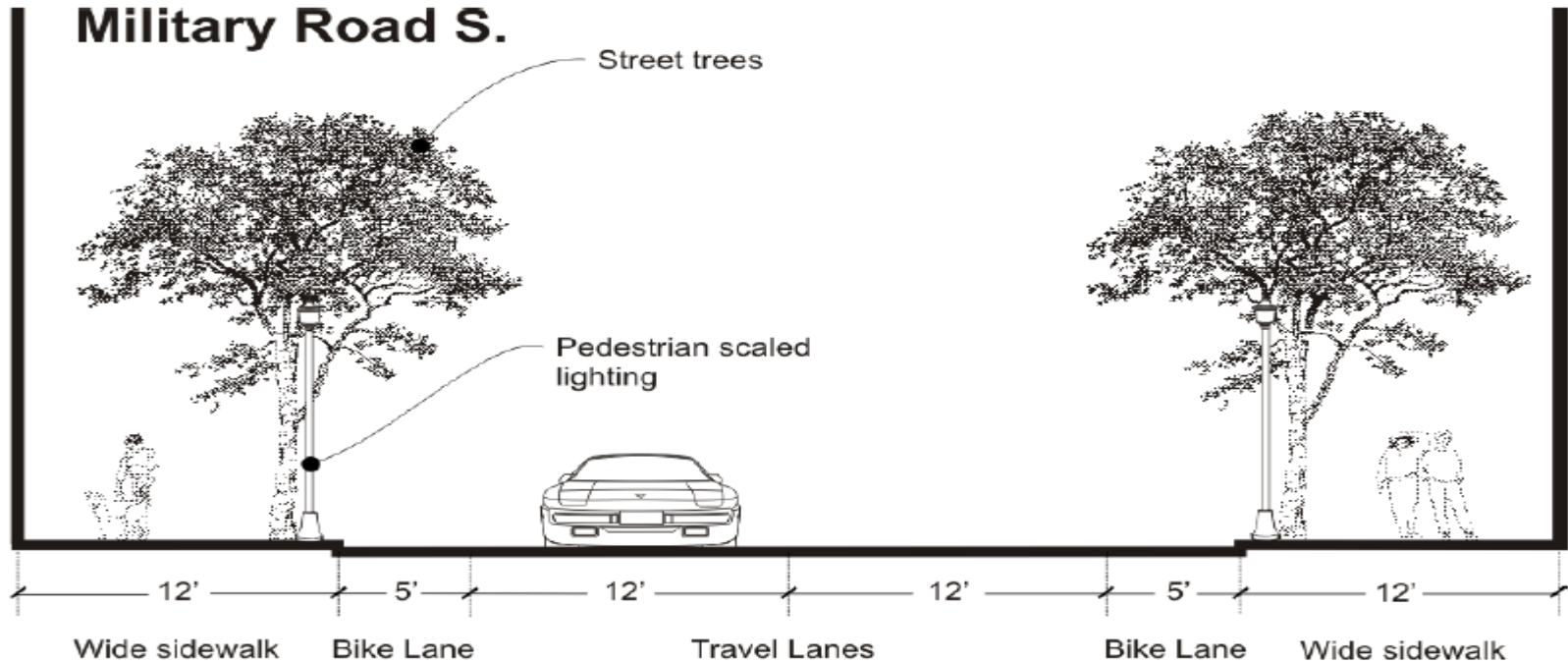

58' within 60' of ROW

Military Rd. S. – CIP Street Section

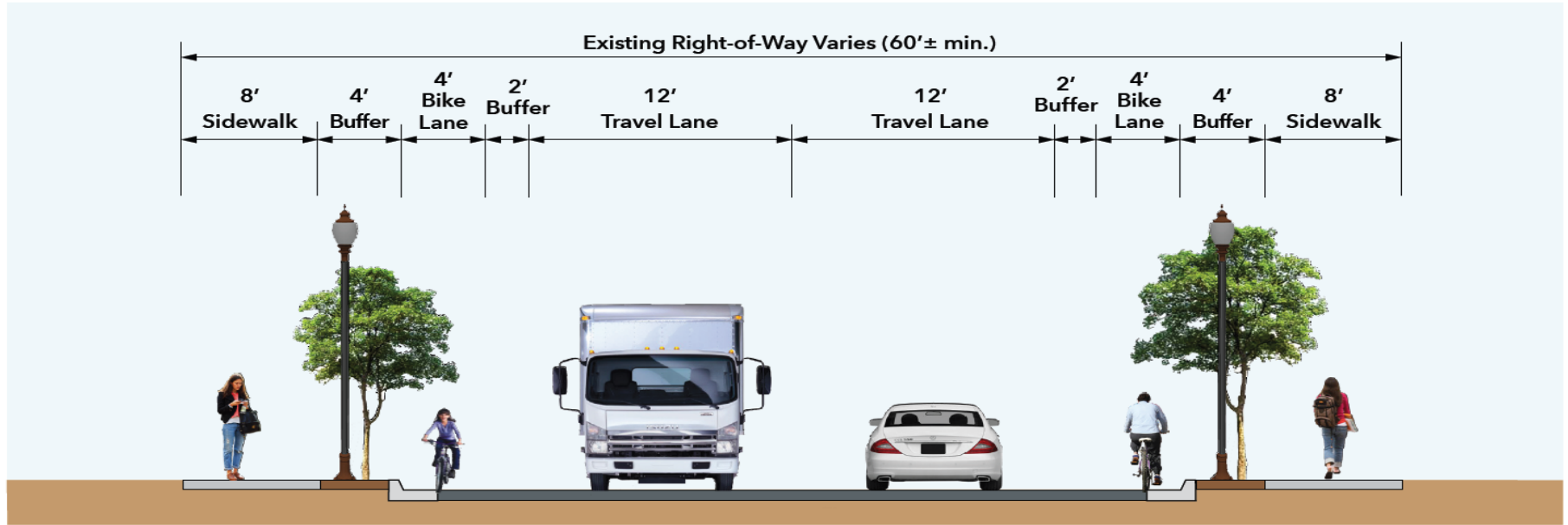

Military Road S. Section

S 152nd St. to S 150th St.

Urban Design Recommendation

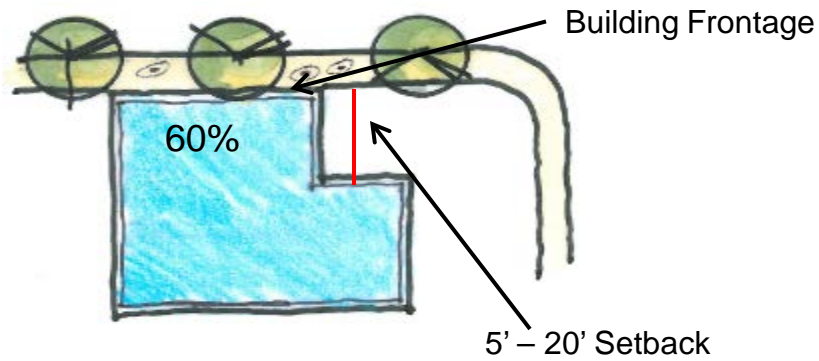
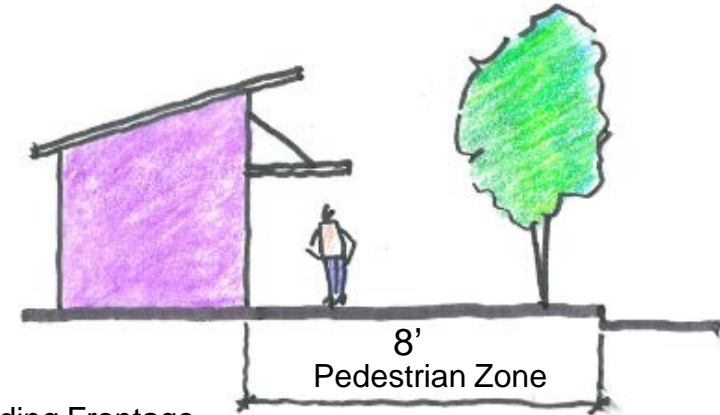
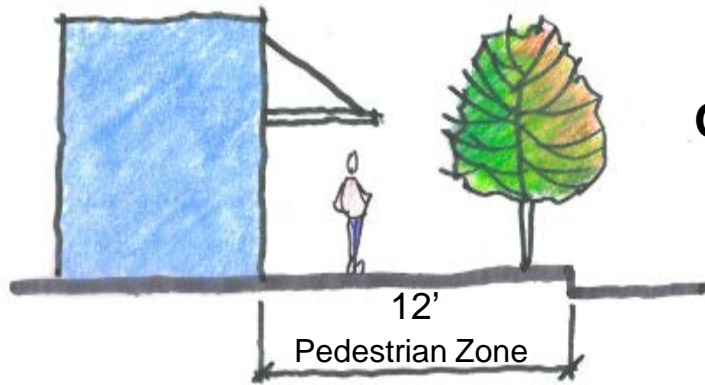

Option B

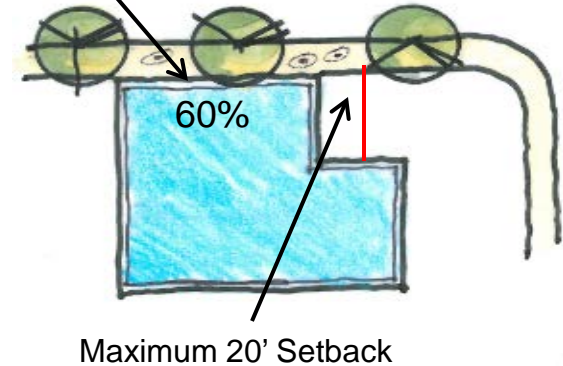

S. 154th Street, North/South Side (east between 32nd Ave. S. to IB)

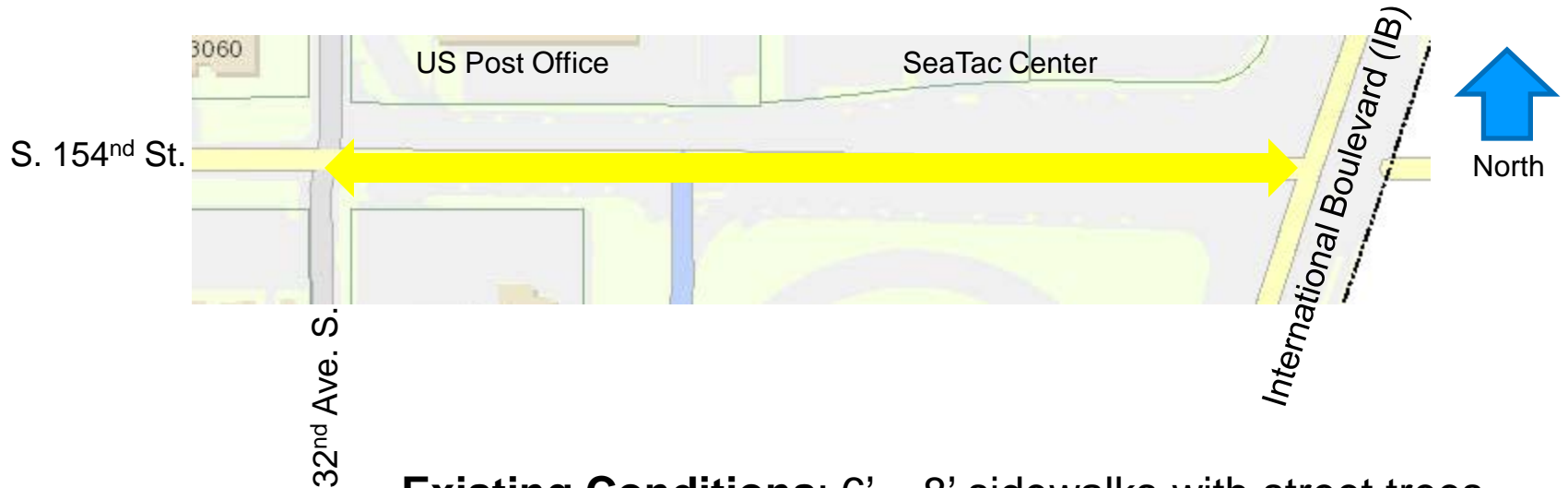

Existing Conditions: 6' – 8' sidewalks with street trees
Along the north/south side of S. 154th Street

Urban Design Recommendation

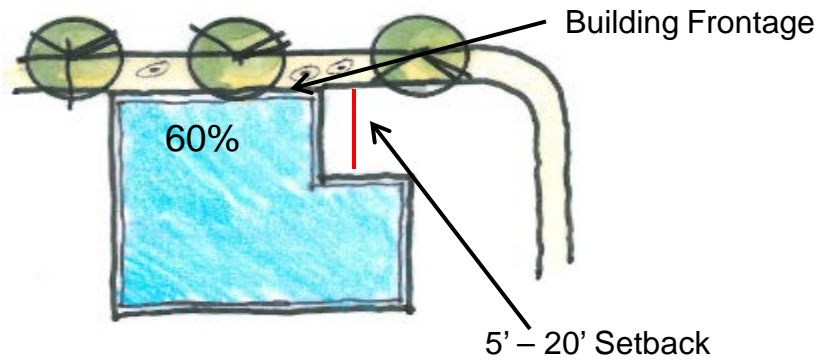
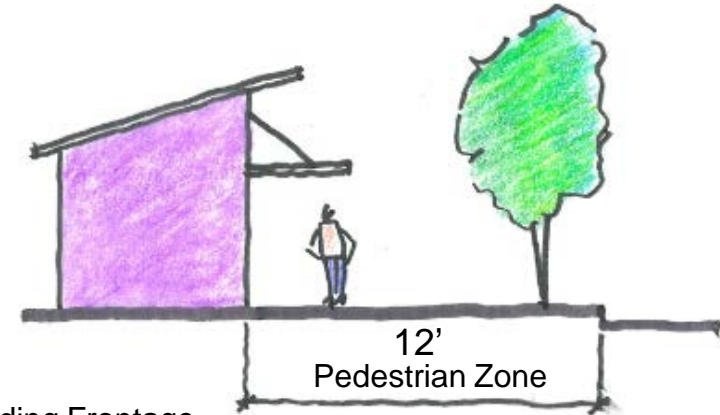
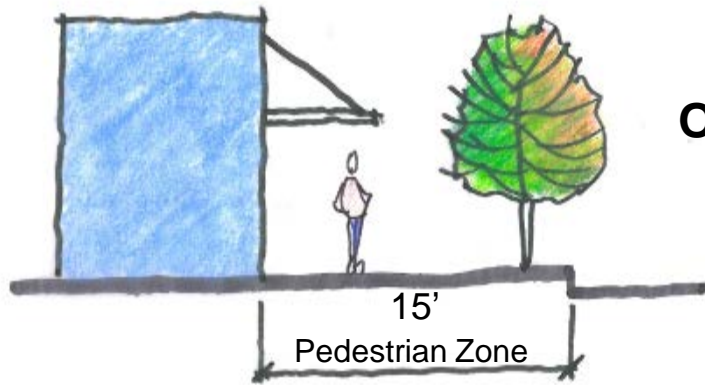

Option B

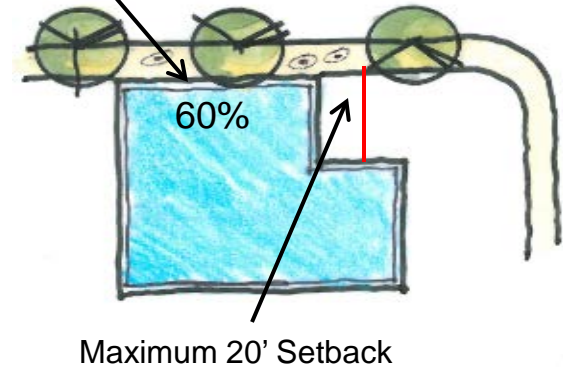

S. 154th Street, North/South Side (west of 32nd Ave. S. to District Limit)

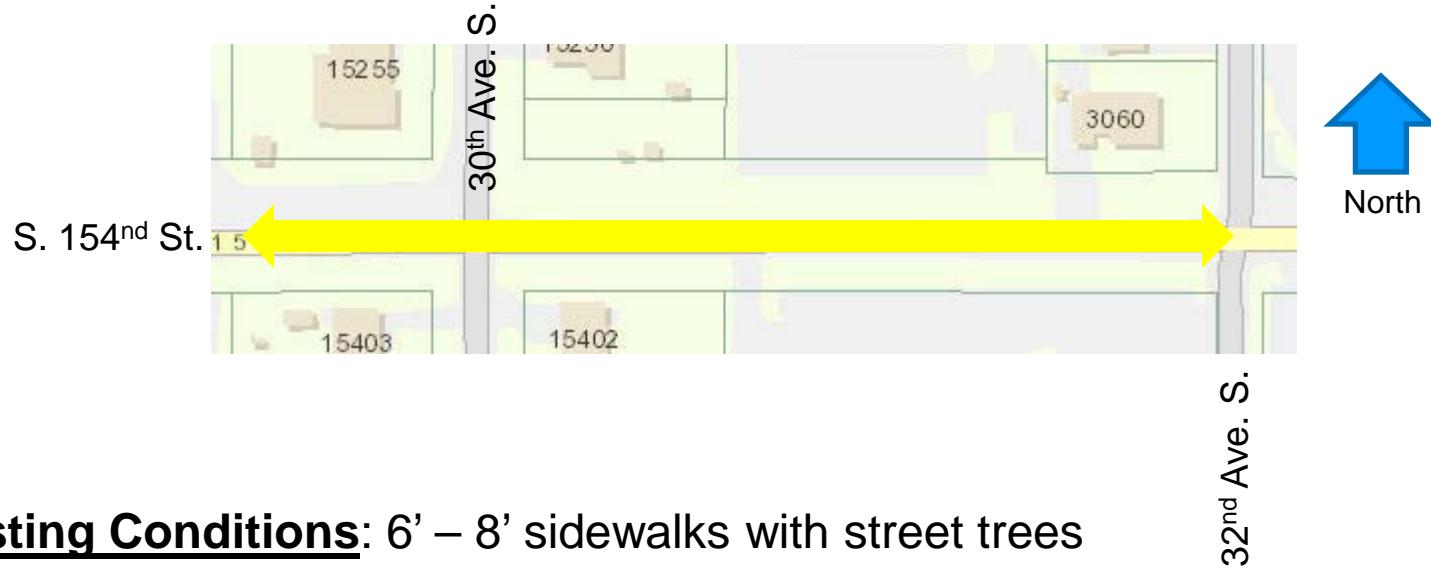

Existing Conditions: 6' – 8' sidewalks with street trees
Along the north/south side of S. 154th Street

S. 154th St Station Area Action Plan west of 32nd Ave. S. Recommendation

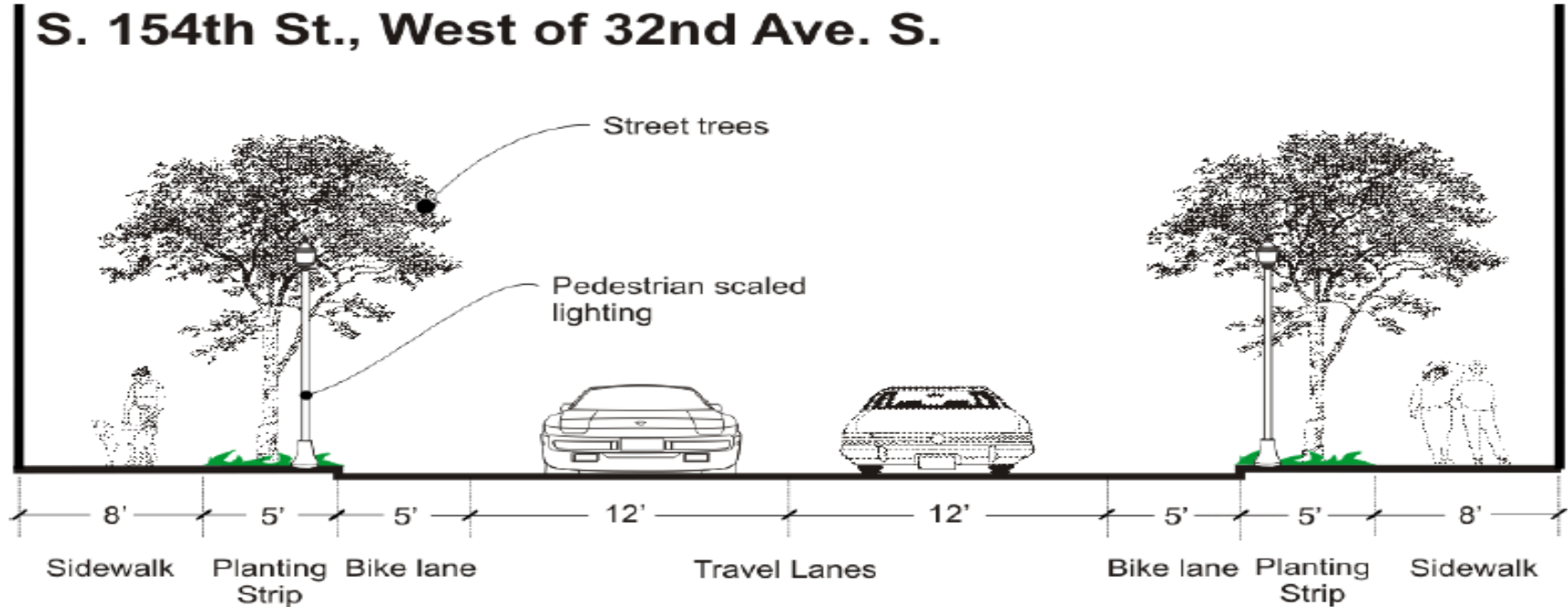

60' within 60' of ROW

Urban Design Recommendation

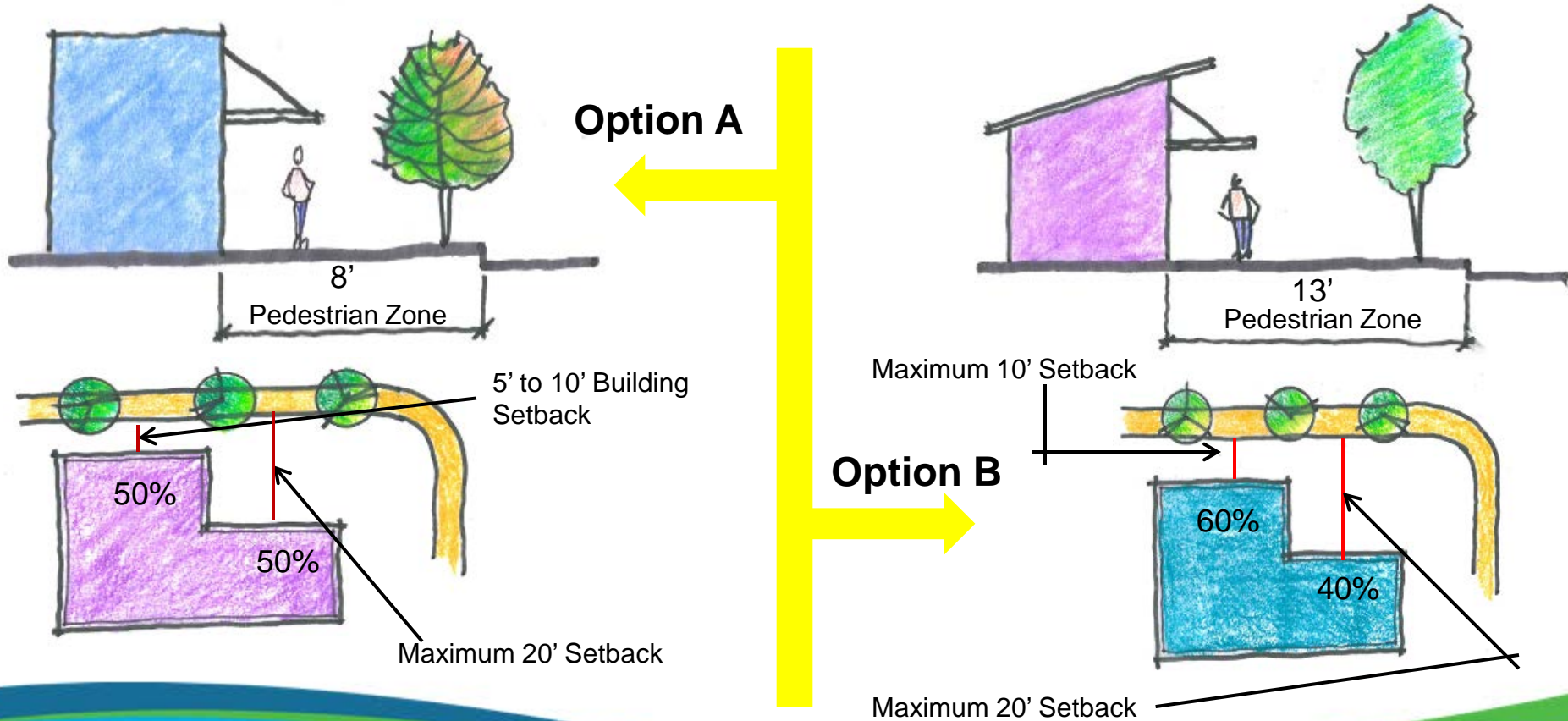

32nd Ave. S., west/east Side of Street

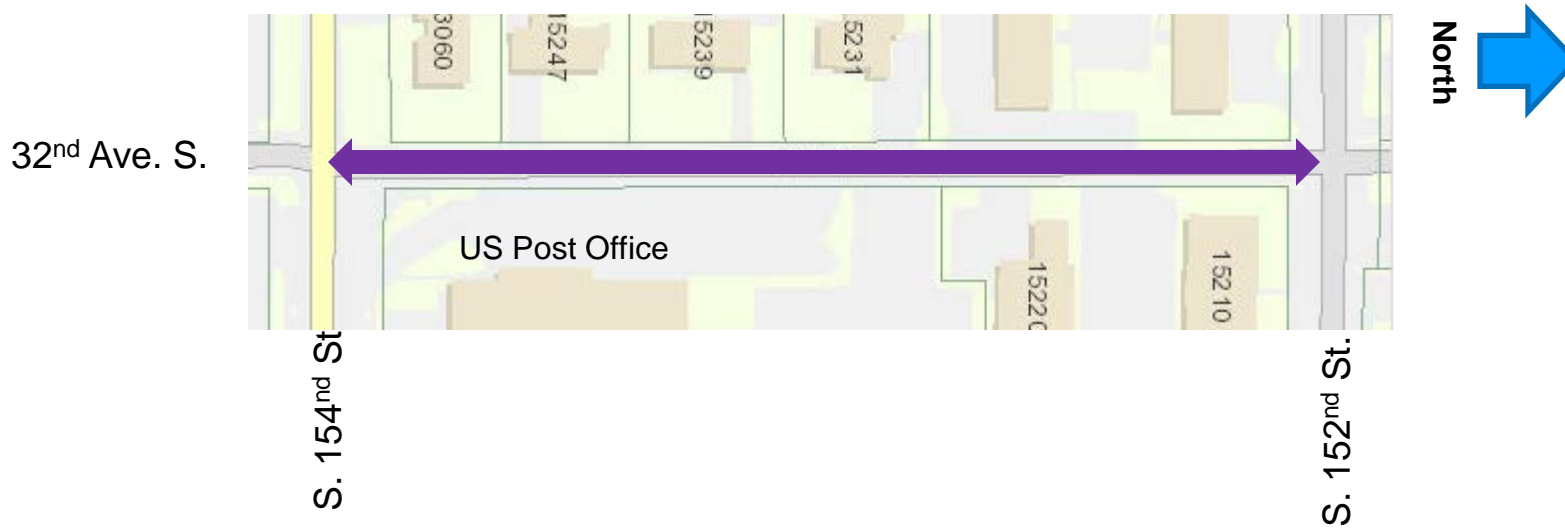

Existing Conditions: No sidewalks, except approximately 5' sidewalks along the east side of the street adjacent to the US Post Office site; 30' of ROW

S. 154th St Station Area Action Plan

32nd Ave. S. Recommendation

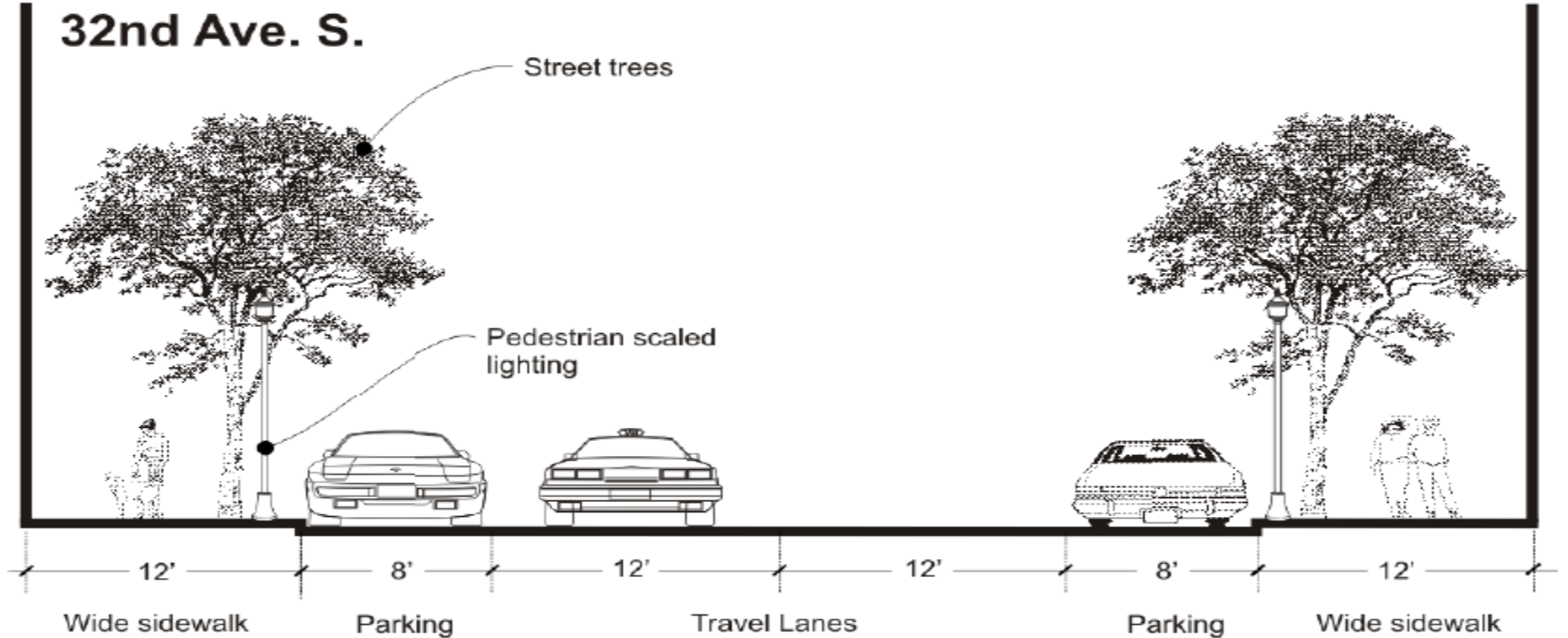

64' within 30' of ROW

Urban Design Recommendation

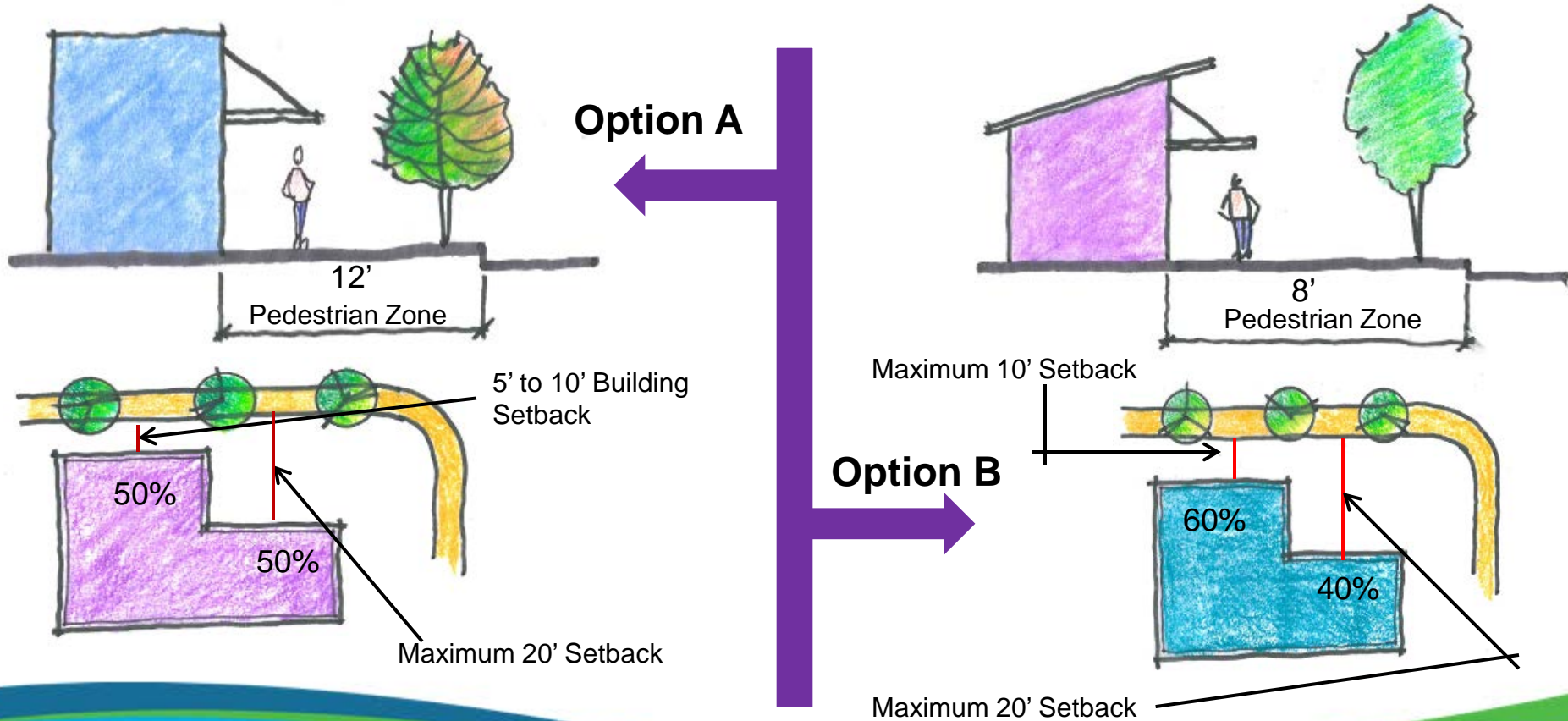

30th Ave. S., north/south Side of Street

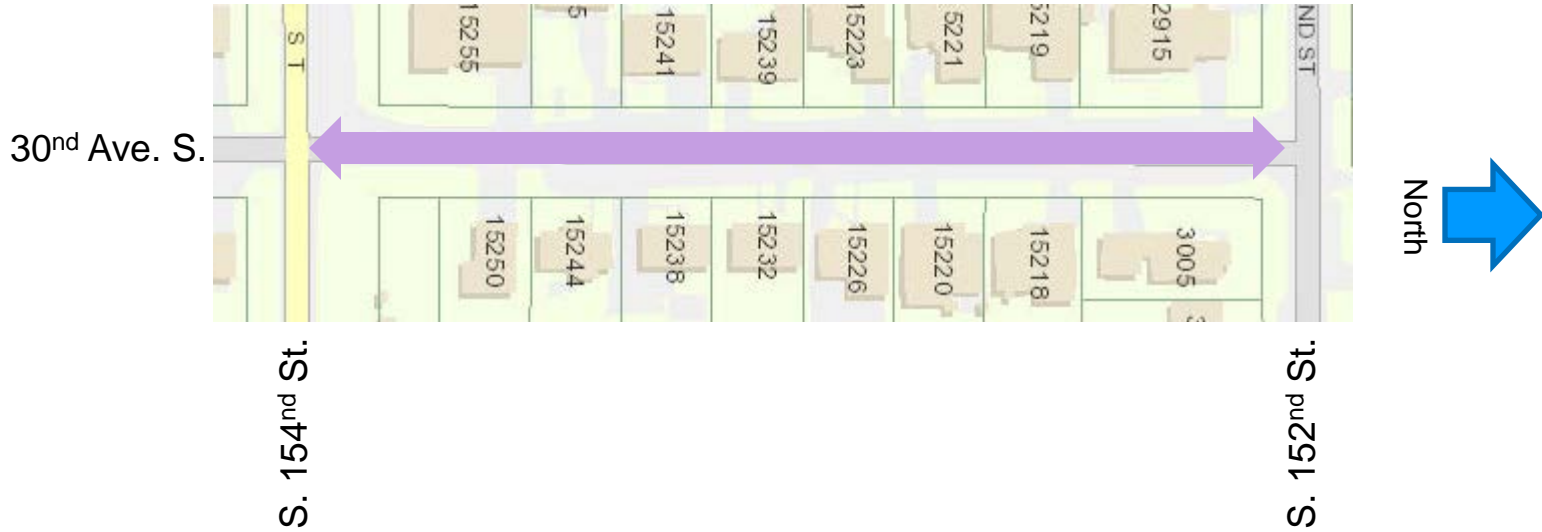

Existing Conditions: No sidewalks, 60' of ROW

S. 154th St Station Area Action Plan

30th Ave. S. Recommendation

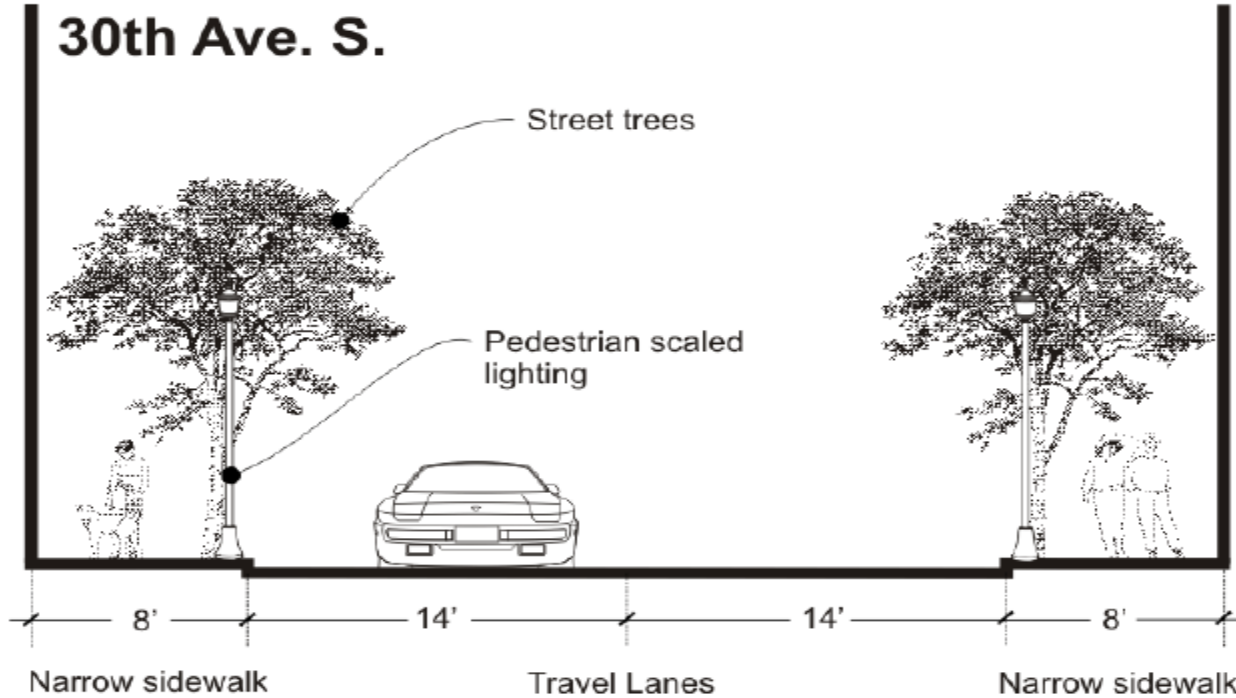

44' within 60 of ROW

Urban Design Recommendation

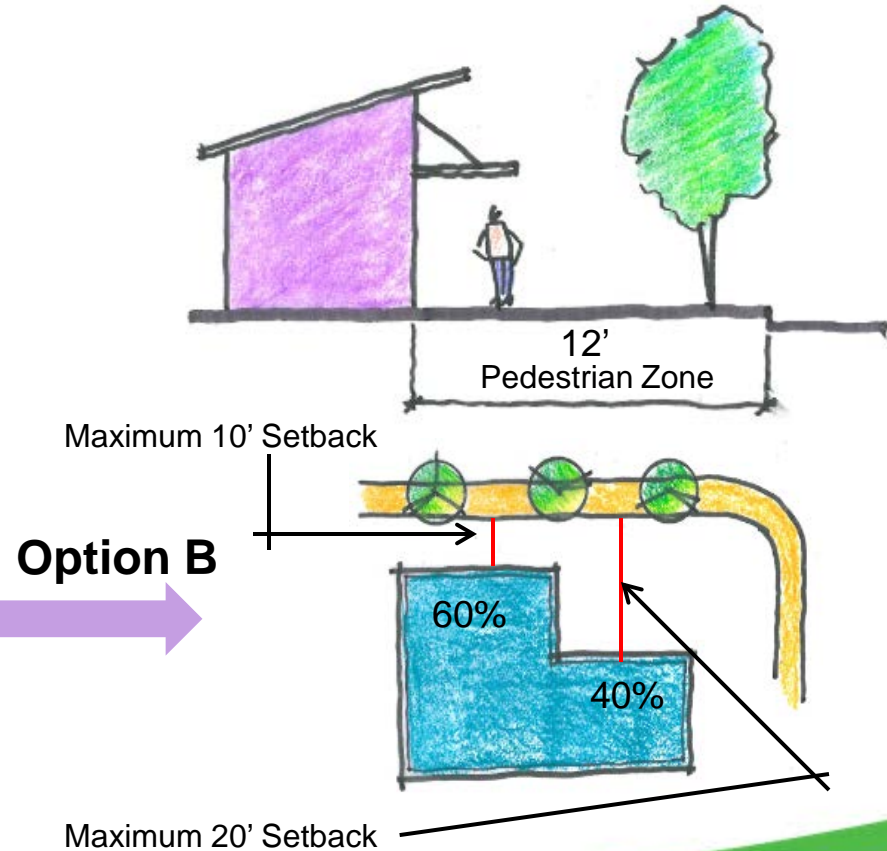
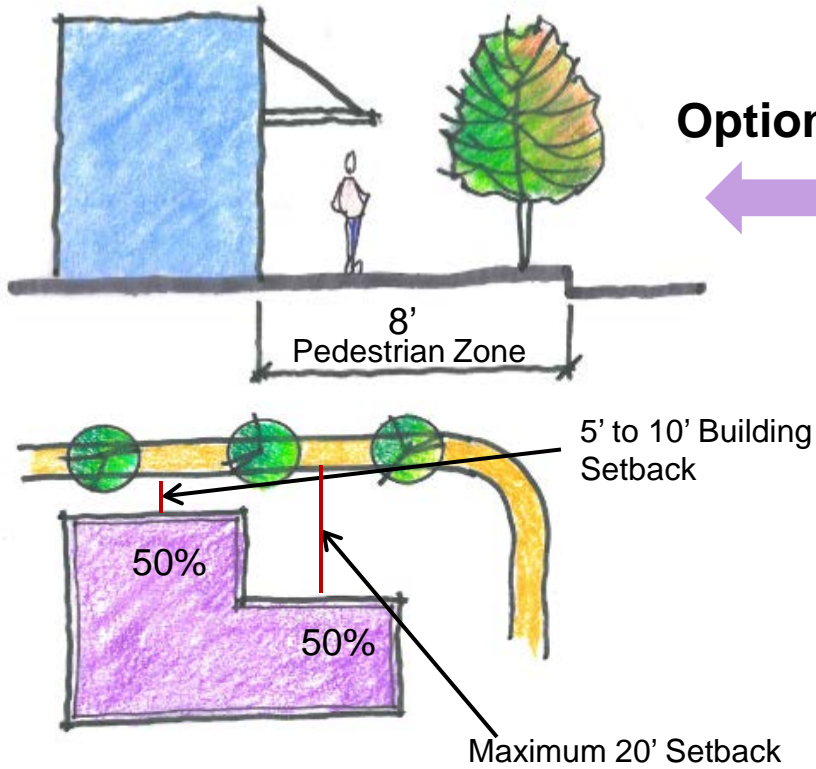

S. 152nd St., east of 32nd Ave. S.

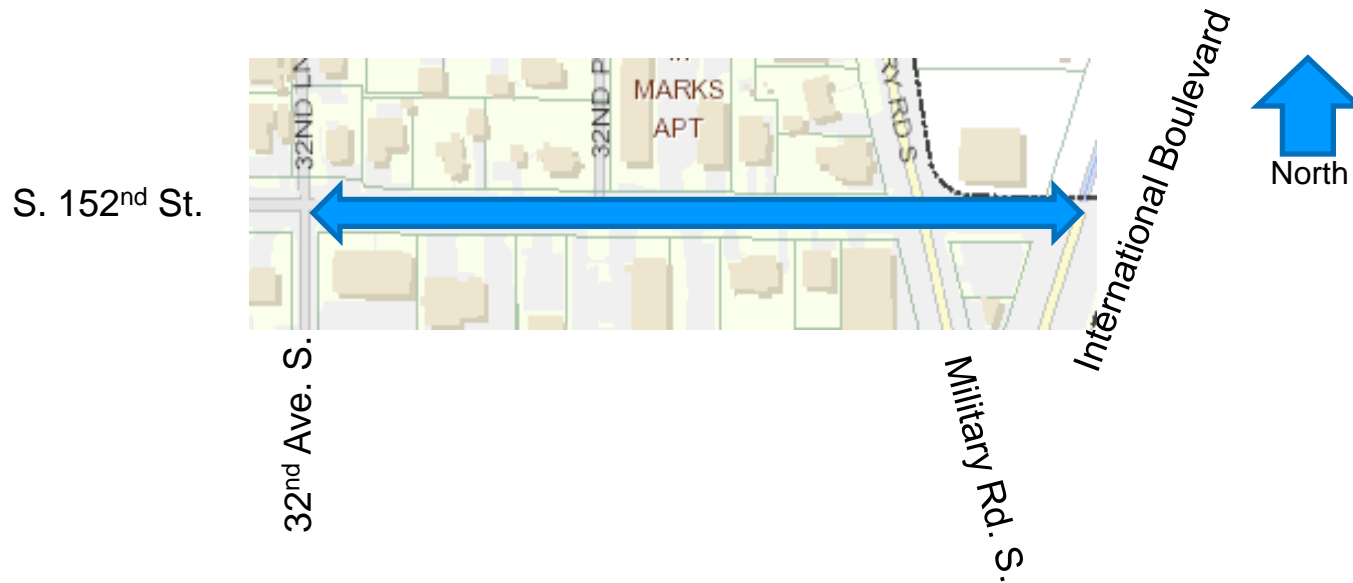

Existing Conditions: No sidewalks, 60' of ROW

S. 154th St Station Area Action Plan

S. 152nd St. Recommendation

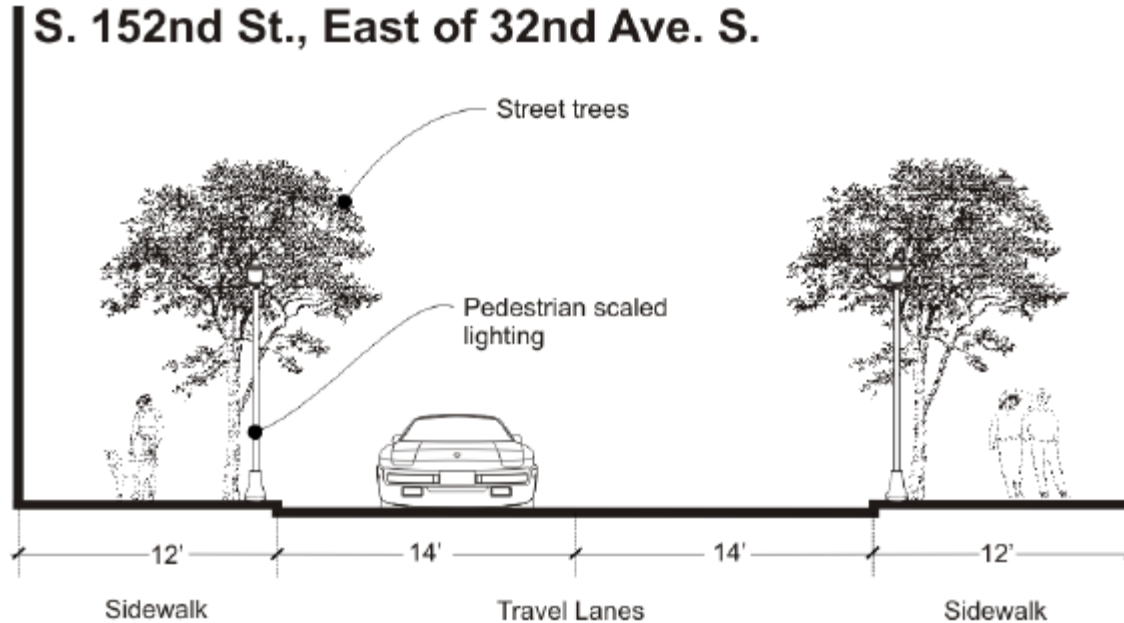

52' within 60' of ROW

Urban Design Recommendation

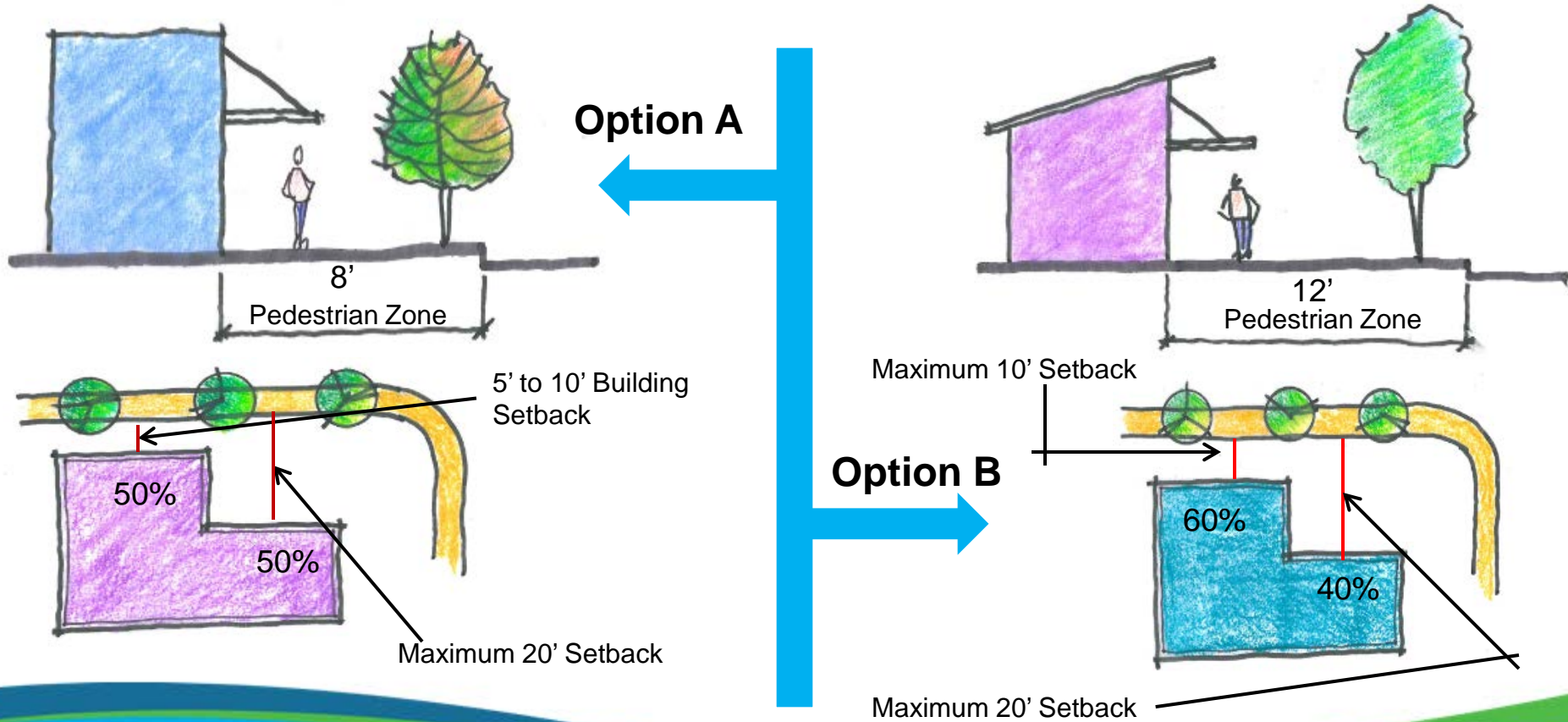

S. 152nd St., west of 32nd Ave. S.

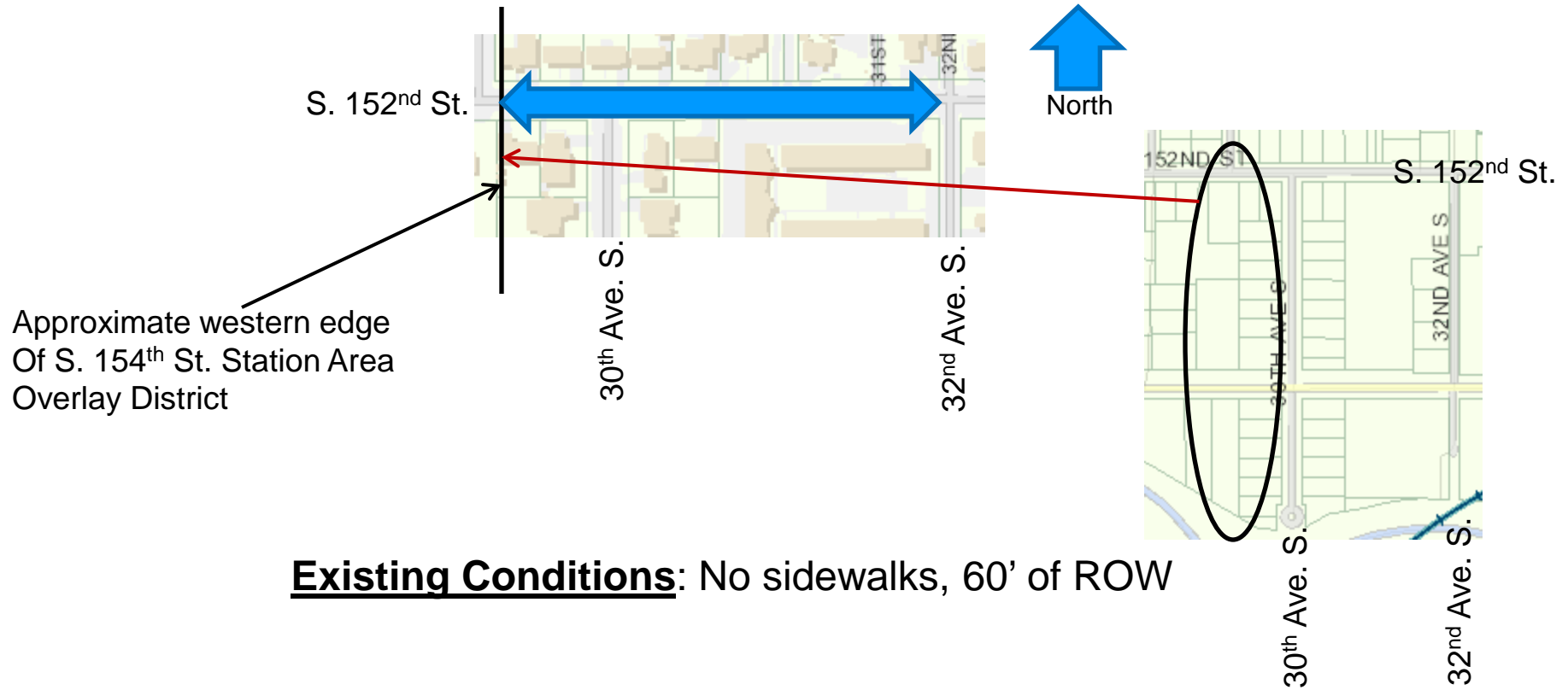

Existing Conditions: No sidewalks, 60' of ROW

S. 154th St Station Area Action Plan

S. 152nd St. Recommendation

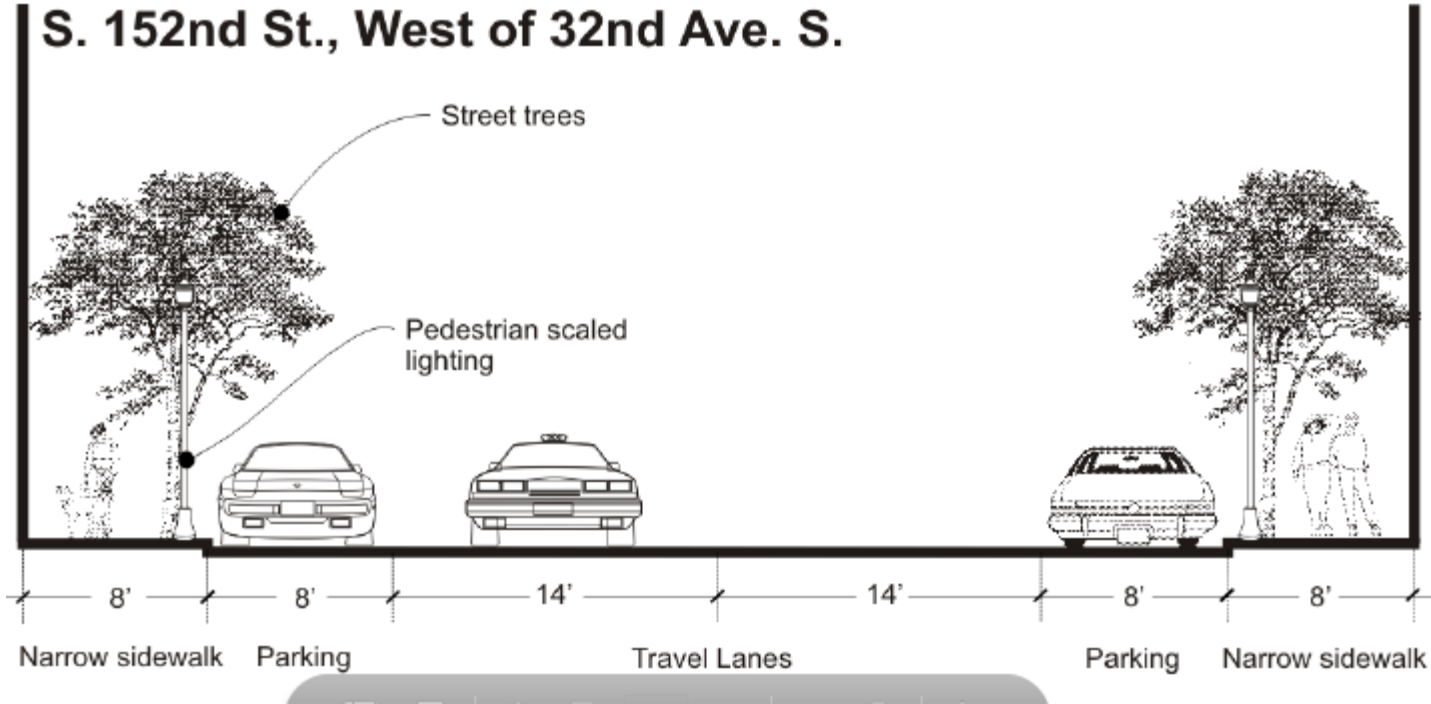

Urban Design Recommendation

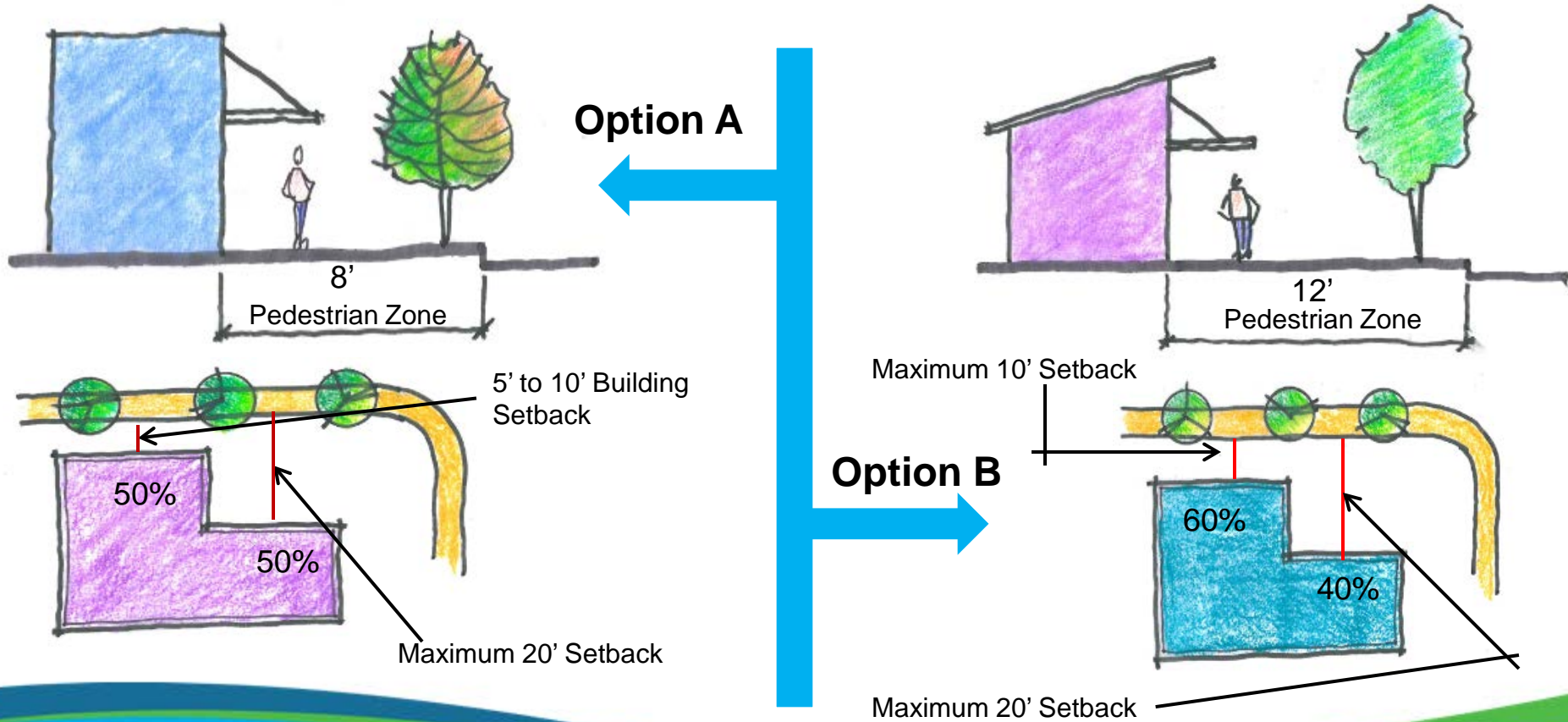

Questions?

