

CITY OF SEATAC
COMMUNITY BUILDING COMMITTEE MEETING MINUTES
March 26, 2014

Members present:

Jean Blackburn, Abdirahman Hashi, Virginia Olsen, Pat Patterson, Keith Siebler, Matthew York and alternate Nibret Aga.

Members absent:

Abdiwali Mohamed.

1. Call to Order

Virginia Olsen called the meeting to order at 5:32 p.m.

2. Approval of Minutes

There were no objections to approving the February minutes as written. It was noted that the minutes won't indicate that the meeting was held off site or that councilmembers and several others from the community attended the February meeting.

3. Community Conversations

Committee members shared information about events and experiences in the community and other observations. Gwen Voelpel shared information from Resource Conservation/Neighborhood Programs Coordinator Trudy Olsen on upcoming Earth Week and spring recycling events (Attachment A).

4. Public Comment

There was one public comment.

5. New Business

A. Code Enforcement Outreach

Code Enforcement Officer Barbara Canfield presented information to the committee regarding sections of the SeaTac Municipal Code that she enforces, as well as examples of problem properties (Attachment B). The group asked questions about code enforcement, including the process used to attempt to elicit voluntary compliance before other action takes place and limitations on enforcement in both resources and policy direction. Barbara also shared brochures used to educate residents on code enforcement (Attachment C). Building Official Gary Schenk and Assistant City Attorney Julia Yoon were also in attendance.

B. Work Plan Development

The committee discussed programs and projects they wish to learn more about over the next several months to a year and agreed on the following items:

1. Explore model that other municipalities are using to reach out to diverse communities—Renton and Tukwila in particular—and see how they might be customized to SeaTac. This was your first priority. Per your request, I will see if Colleen can provide some information on models, funding, work plans, etc. Keith will find out what he can about Seattle's model.
2. Explore need for additional code enforcement officer including funding for enhanced outreach/communications.
3. Look into providing information in other languages (possibly start with top two or three, which are 1. Spanish; 2. Somali; 3. Punjabi) including code enforcement information.
4. Start requesting information on community garden opportunities. To this end, Pat will check with Parks & Rec on master gardeners who might have an interest from the botanical garden.
5. Display photos of community members on the walls of City facilities, like they do at King County Housing Authority.
6. Explore internships in City offices, as well as businesses, in partnership with the Highline School District.
7. Contact organizations on the master list created by the committee to help build bridges between communities. To this end, Matthew will contact Rotary to determine its regular meeting date/time/location.
8. Attend the Back to School Fair in some capacity.

The members agreed to add these items to the presentation to the City Council on April 22 with the potential to report back to the Council on their findings before the end of the year.

C. Council Presentation

The committee reviewed the draft outline of the presentation taking place at the April 22 City Council Study Session (Attachment D) and suggested changes to Pat Patterson, including mentioning the work on the list of community organizations, the annual calendar and the group's ground rules for multicultural conversations. The group then discussed logistics of the presentation.

6. Future Meeting Topics

The discussion about future meeting topics resulted in one change to the April agenda items. The committee decided to wait on determining June topics until the April meeting or thereafter. Future meeting topics therefore are:

- A. April 23, 2014: a) Debrief from Council Presentation; b) Work Plan Implementation
- B. May 28, 2014: a) Roles (Rotation and/or Redefinition for Members); b) Back to School Fair Participation
- C. June 25, 2014: TBD

7. **Adjournment**

Virginia Olsen adjourned the meeting at 7:24 p.m.



City of SeaTac Earth Week Events

The City of SeaTac will hold several coordinated events in recognition of Earth Week.



Volunteers do make a difference and when it comes to picking up litter and trash, more participants will make the community cleaner.



City Recycling Collection Event

**Tyee Educational Complex Parking Lot, 4424 S. 188th Street
Saturday, April 19, 9:00 a.m. to 3:00 p.m.**

NO Commercial Loads. NO Yard Debris. Free Confidential Shredding. Limited Rain Barrel Sale. Cash only when fees apply; residents to pay vendors directly. Appliances, scrap metal, fluorescent lights, motor oil and antifreeze, tires, EPS Styrofoam, mattresses/box springs, toilets, propane/helium tanks, gas-powered equipment, cardboard and more.

Fees apply to some items, please contact Trudy Olson at 973.4763 or visit the Public Works section of the City of SeaTac's website.

Annual Community Litter Cleanup Event

**Tyee Educational Complex Parking Lot, 4424 S. 188th Street
Saturday, April 19, 9:00 a.m. to 11:30 a.m.**

Volunteers needed!

Individuals/groups/businesses are encouraged to 'Step Up for SeaTac' and help in this city-wide litter cleanup event and be part of enhancing our community. Volunteers will gather at the Tyee Educational Complex at the area labeled Community Litter Cleanup (adjacent to the Recycling Event rain barrel sale area) and be assigned to a team. Each team will be given gloves, garbage bags, trash pickers and safety vests. Volunteers will be dispatched to areas of the city to clean up and bag trash. Event ends at 11:30 a.m. Team captains will return city equipment. City trucks will pick up trash bags during and after the event.

For more information or to sign up, please contact Resource Conservation/Neighborhood Programs Coordinator Trudy Olson at 973.4763.

Parks Beautification Event

Saturday, April 19, 9:00 a.m. - 11:30 a.m.

Volunteers needed!

Join in and help beautify your SeaTac parks. For more information or to sign up contact Parks Operations Manager Roger Chouinard at 973.4781.

Additional Parks Cleanup Events

For information on the following events, please contact Parks Operations Manager Roger Chouinard at 973.4781.

Boeing's Highline SeaTac Botanical Garden Cleanup Event

Saturday, April 19, 9:00 a.m.-1:00 p.m.

Neighbors Without Borders Action Committee Cleanup Event

Saturday, April 19, 9:00 a.m.-1:00 p.m.

Arbor Day Event

Angle Lake Park, 19408 International Blvd.

Wednesday, April 23, 10:00 a.m.

Join us for a tree planting event at Angle Lake Park. Parks Operations Manager Roger Chouinard will be working with local area students for this Arbor Day Event.

South Seattle Household Hazardous Waste Collection Facility

8105 Fifth Ave. South, Seattle
(South of the First Avenue South Bridge)

Open Thurs. - Sat., 9:30 AM to 4:30 PM
Year-round, except public holidays

Household Hazardous Wastemobile
La colección de desechos peligrosos

For dates/locations of the regular 'roving' Wastemobile visit <http://www.lhwmp.org/home/HHW/wastemobile.aspx>

Auburn Wastemobile

at The Outlet Collection (formerly SuperMall)

Wastemobile is in northwest corner of the mall next to Sports Authority.

Saturdays and Sundays 10AM to 5PM
Closed Nov 29-30 and Dec 27-28

Bring: Oil-based paint, adhesives and glues, mercury products, pesticides, cleaning products, aerosol cans (not empty), propane tanks (less than 8 gallons), auto supplies (antifreeze, brake fluid, gasoline, oil - **separate motor/ crank case oil from all other fluids**), thinners/ solvents, and lead & household batteries.

Don't bring: Latex paint, electronics, tires, explosives, medical waste, empty containers, garbage, smoke detectors, medications.

DANGER! WARNING!
TOXIC PRODUCTS!

Use them up or take them to the wastemobile or a hazardous waste collection site.



Call for directions/information:

Household Hazards Line
206.296.4692

www.lhwmp.org/home/HHW/disposal-locations.aspx



City of SeaTac
Spring Recycling
Collection Event

For King County Residents

Saturday
April 19, 2014

Type Educational Complex
Parking Lot
4424 South 188th Street
Hours: 9 AM to 3 PM

No vehicles may enter after 3 pm.

No commercial loads allowed.

No yard debris accepted

For event information, alternative formats, or disability accommodations call 206.973.4763.

TTY Relay: 711

City of SeaTac
Public Works Department
4800 South 188th Street
SeaTac, WA 98188-8605

www.ci.seatac.wa.us
206.973.4763



Printed on Recycled Paper



SPECIAL RECYCLING COLLECTION EVENT

No Yard Debris! No Commercial Loads. No flat bed or dump trucks allowed. We reserve the right to refuse oversized, commercial, contaminated, excessive, or unacceptable loads. **Cash only when fees apply. Residents pay vendors directly.**

Appliances & Scrap Metals: Washers, dryers, stoves, hot water tanks, empty bbqs, lawnmowers, microwaves, auto parts, cast iron, steel. **Remove all fluids or liquids. No car bodies. No items with chemicals.**

Batteries: Car, truck and marine lead acid batteries. Household alkaline, rechargeable and button batteries. Please sort large quantities by type.

All Fluorescent Tubes/Bulbs: Limit 10 per vehicle.

Oil, Oil Filters & Antifreeze: Motor oil, oil filters, diesel fuel, kerosene, antifreeze, transmission & steering fluids. **Do not mix fluids. No gas or brake fluid.**

Refrigerators & Freezers & Air Conditioners: **\$25 for each.**

Tires: Auto & motorcycle tires. Tires with rims allowed. Limit 10 per vehicle.

Electronics: Cell phones, printers, keyboards, fax machines, scanners, VCRs, CD/DVD players and stereos. **No TVs, computers/laptops/monitors.**

EPS Styrofoam and Packing Peanuts: Make sure the EPS (look for the #6 or EPS inside the recycling symbol) is clean and free of any plastic film, cardboard, hard plastics, screws or metal. Dirty or wet EPS will not be accepted. **Packing peanuts need to be in a box or bag. No food containers.**

Clothing & Household Items: Clothing (all types, sizes) & reusable household items in good condition and useable "as is". No furniture or items needing repair. If not accepted, you must take them back. Donations benefit Northwest Center. Tax receipts available.

Confidential Material Shredding: LetMay Mobile Shredding will be providing secure document destruction services. Limit: 3 boxes per vehicle.

Mattresses/Box Springs: \$10 per piece. Items must not be excessively stained, wet, nor have bed bugs.

Toilets & Porcelain Sinks: \$10 per item. Please have all wooden and plastic toilet seats removed.

Propane & Helium Tanks: 5-gallon tank is \$5; small 1-gallon tank is \$1 (basic fee of \$1 per gallon applies).

Cardboard/Books/Magazines: Please flatten cardboard.

Vendors at the event reserve the right to reject any items that do not meet their requirements.

RAIN BARREL SALE - at Event Site

Limited amount of rain barrels available!
9 AM to Noon or until they are sold!

SeaTac Residents Only

Please bring proof of residency.

\$25 each, cash only -

limit TWO (2) per customer

(subsidized by City of SeaTac & King County)

E-Cycle Washington: Washington has a FREE recycling program called "E-Cycle Washington" for computers, computer monitors, laptops, portable DVD players and televisions. Computer peripherals such as keyboards, mice, and printers are not included in this program but will be accepted at Seatac's Recycling Collection Events. To find authorized E-Cycle Washington collection locations call **1-800-RECYCLE** or visit **1800recycle.wa.gov**.
Latex Paint Disposal: Mix latex paint with an equal amount of kitty litter or mix with a commercial paint hardener according to directions. Stir in completely. Let the paint dry. Once dry, put the can (with the lid off) in your garbage container.

Need to recycle items not accepted at the Seatac Fall Event? Visit King County Solid Waste Division's "What do I do with...?" website at <http://your.kingcounty.gov/solidwaste/wdidw/>

CODE COMPLIANCE PRESENTATION

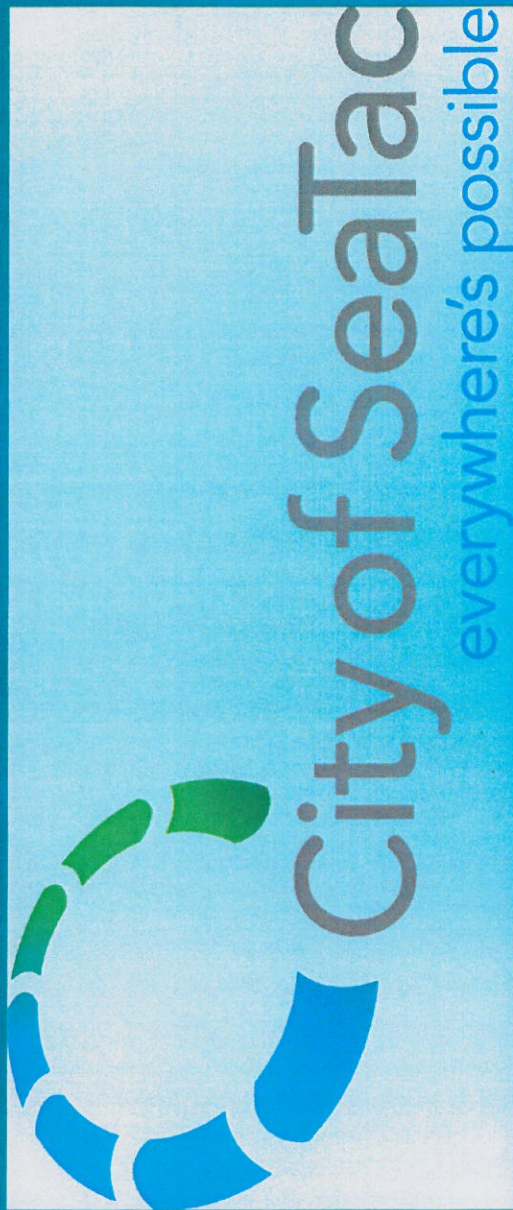

Presented to
The Community Building Committee
Date: March 26, 2014



SEATAC MUNICIPAL CODES

- SMC 7.15.020
- SMC 7.25.100
- SMC 15.15.180



PROPERTY MAINTENANCE

- **Chapter 7.15
PROPERTY MAINTENANCE**

- Sections:

- **7.15.010** Definitions.

- **7.15.020** Duty to maintain property.

- **7.15.030** Declaration of public nuisance.

- The definitions set forth in Chapter **15.10** SMC, as presently existing or as may subsequently be amended, shall apply to this chapter and, in addition, the following definitions shall apply:

- A. “Junk” means discarded, broken or disabled material including, but not limited to, furniture, appliances, discarded lumber, toys, or other items that are not in functioning condition.

- B. “Owner” means any person owning property, as shown on the real property records of King County or on the last assessment roll for taxes, and shall also mean any lessee, tenant, occupant or other person having control or possession of the property.

- C. “Property” means land and any buildings or structures located thereon.

- D. “Trash” means waste food products and other household garbage. (Ord. 02-1005 § 1: Ord. 91-1014 § 1)

- **7.15.020 Duty to maintain property.**

- No person owning, leasing, renting, occupying, being in possession or having charge of any property in the City, including vacant lots, shall maintain or allow to be maintained on such property, except as may be permitted by any other City ordinance, any of the following conditions visible from any public street or alley, or from any other private property:



PROPERTY MAINTENANCE

- A. Junk, trash, discarded items or salvage materials;
- B. Any accumulation of material including, but not limited to, bottles, cans, glass, plastic, ashes, scrap metal, broken stone or cement, rags, boxes, crates, packing cases, tools, equipment, and packing material;
- C. Household items, furniture and appliances intended for indoor use that are stored or used outdoors. For the purposes of this section, decks, carports and open garages are considered outdoors;
- D. Shopping or baggage carts;
- E. Indoor personal items stored outdoors for more than twenty-four (24) hours including, but not limited to, clothing, bedding, toys, cooking and eating utensils, newspapers and magazines;
- F. Building, plumbing, electrical and mechanical materials unless neatly stacked and intended to be used for improvements to the premises on which it is stored, within six months;
- G. Firewood unless neatly stacked and intended to be used on the premises on which it is stored;
- H. Dead, decayed, diseased or hazardous trees, which are dangerous to public health, safety and welfare;
- I. Berry vines which exceed an average height of three (3) feet, except on vacant lots provided the berry vines do not encroach on adjacent properties;
- J. Any accumulation of weeds or grass which exceeds twelve (12) inches in height;
- K. Regardless if visible from adjacent property, any attractive nuisances dangerous to children, including but not limited to, equipment, machinery, unused refrigerators and freezers, excavations, wells or shafts. (Ord. 02-1005 § 2; Ord. 95-1024 § 1; Ord. 91-1014 § 2)



PROPERTY MAINTENANCE





PROPERTY MAINTENANCE





PROPERTY MAINTENANCE





PROPERTY MAINTENANCE





VEHICLE STORAGE

- **7.25.100 Storage of certain vehicles and components prohibited.**
- No person owning, leasing, renting, occupying, being in possession or having charge of any property in the City, including vacant lots, shall retain or store, except as may be permitted by any other City ordinance, any of the following:
 - A. One or more wrecked, dismantled or partially dismantled, inoperative, or unlicensed (vehicle licensing plates and current tabs) and uninsured vehicles;
 - B. Body parts, engines or drive-train parts, or any other parts, assemblies or components of automobiles and other motor vehicles;
 - C. Any pickup truck campers or canopies (not mounted on a pickup truck), unless safely located within the driveway or side yard, but not within the required side yard setback. (Ord. 02-1007 § 1: Ord. 91-1015 § 2)



INOPERABLE VEHICLES





INOPERABLE VEHICLES





PARKING

- **15.15.180 Single-Family Maximum Off-Street Vehicle Parking Requirements**
- Within the single-family zones (UL-5,000; UL-7,200; UL-9,600; and UL-15,000), the following maximum off-street parking standards shall apply. These standards shall be applicable to new and existing parking areas and are in addition to the off-street parking standards for a single-family residence specified under SMC **15.15.030**.
- A. All motor vehicles, trailers, boats and RVs must be parked on one (1) of the approved surfaces listed in subsection (B) of this section.
- B. All required off-street parking spaces shall be constructed in conformance with SMC **15.15.030**, **15.15.100**, and **15.15.110**. Additional off-street parking surfaces shall be constructed of one (1), or a combination, of the following materials:
 1. Concrete (four (4) inch Portland cement concrete over compact native soils); or
 2. Blacktop (two (2) inch asphalt concrete pavement over gravel section as described under subsection (B)(3) of this section); or
 3. Two (2) inches of five-eighths (5/8) minus compacted rock, provided mud or other fine material do not work their way to the surface of the rock. Alternate sized minus compacted rock may be used upon approval by the City;
 4. Any other configuration or materials, approved by the City, that maintains a durable uniform surface.
- C. Off-street parking surfaces outside of structures on-site may cover a maximum of one thousand two hundred (1,200) square feet or ten percent (10%) of the lot surface, whichever is greater.
- D. No more than fifty percent (50%) of the front yard or eight hundred (800) square feet, whichever is smaller, can be driveway or off-street parking surface. For the purposes of this section, the front yard shall be the area between the right-of-way and the portion of the house frontage that is farthest from the right-of-way. The width of the front yard shall extend to each side property line. (See Figure 15.15.180a).



PARKING

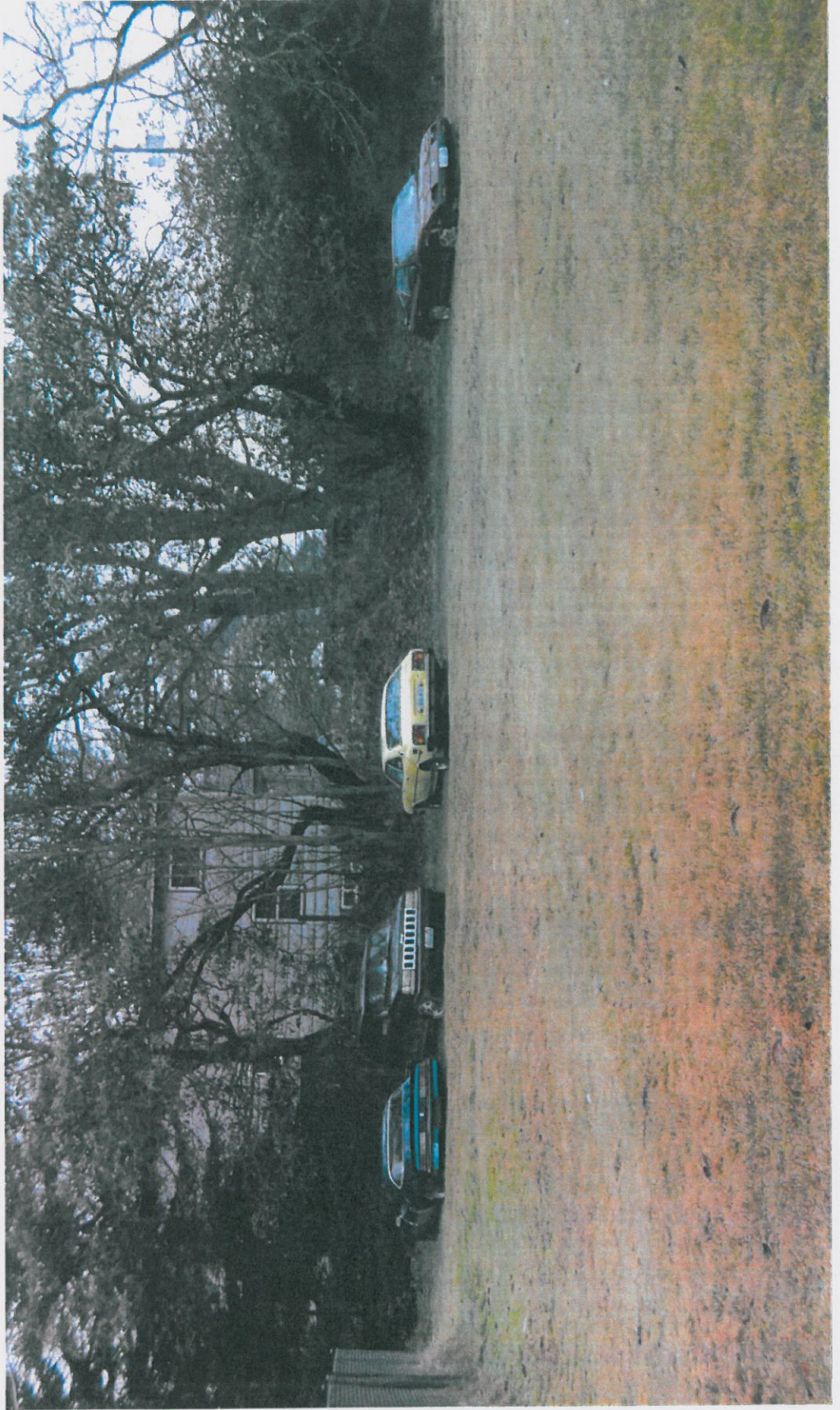



PARKING

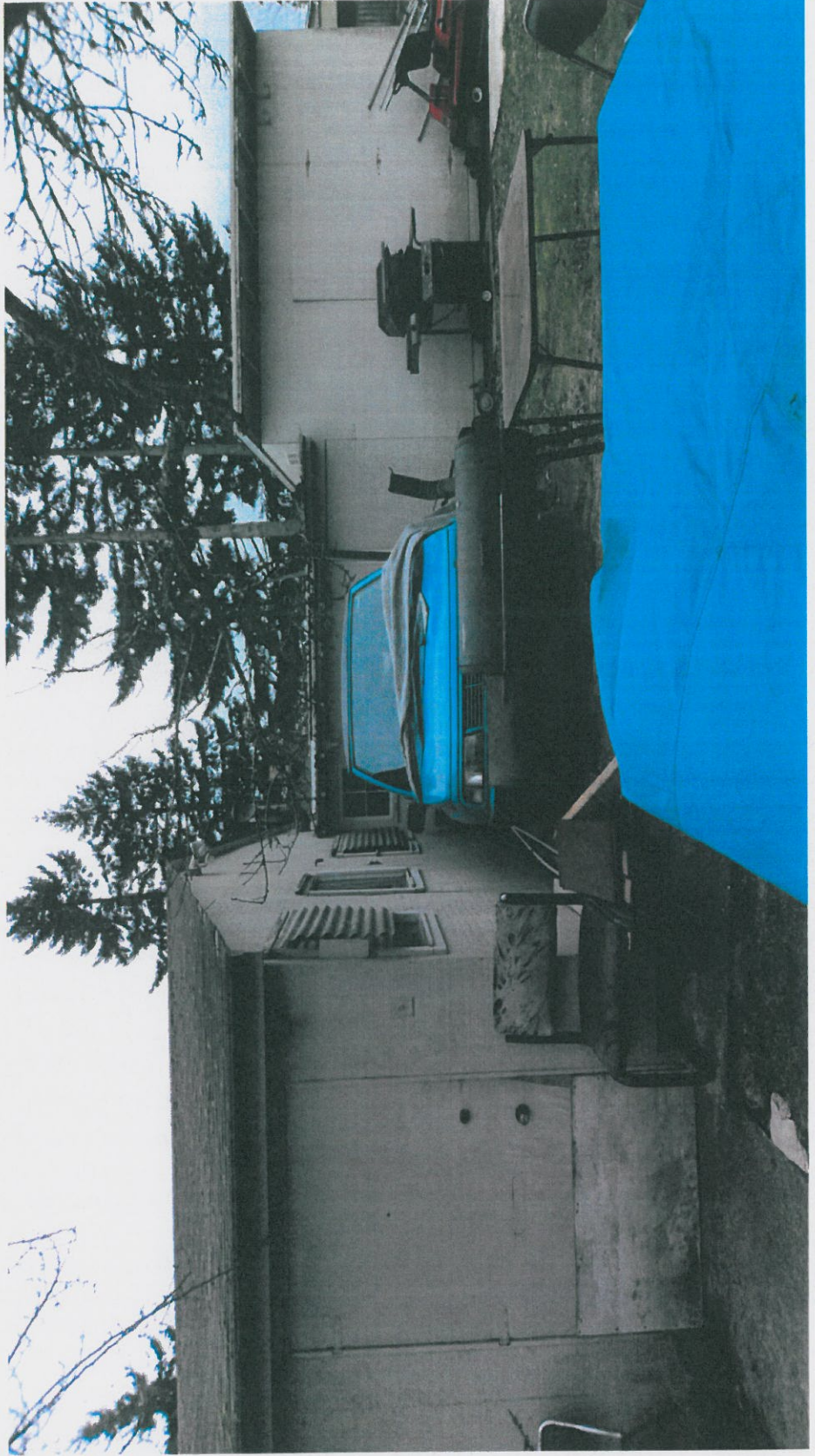



PARKING

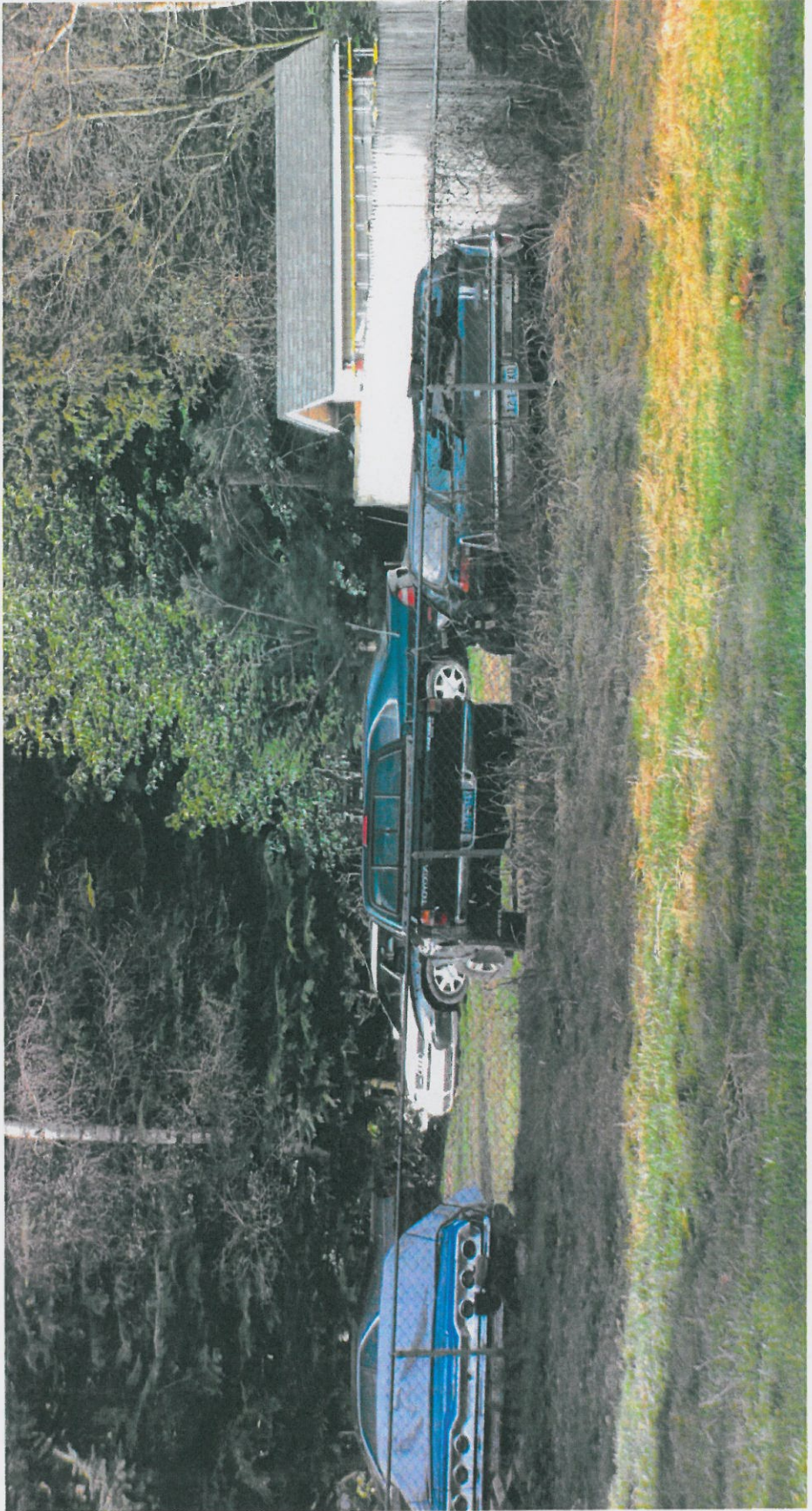



A CLEAN NEIGHBORHOOD SAYS

- The people who live here care about their community.
- This is **not** a good place to commit a crime
- A homeowner or business owner may think twice about being “the one” to bring down the neighborhood.
- This is a good, safe area to live in and raise your family.



OTHER

CODE ENFORCEMENT CODES

- 5.05.020 Business license required
- 7.35.010 Graffiti deemed nuisance
- 8.05.360 Noise
- 13.210.010 International Property Maintenance Code
- 15.16.025 General Sign Provisions
- 15.16.089 Garage and Yard Sale Signs
- 15.17.020 Regulation of Home Occupations







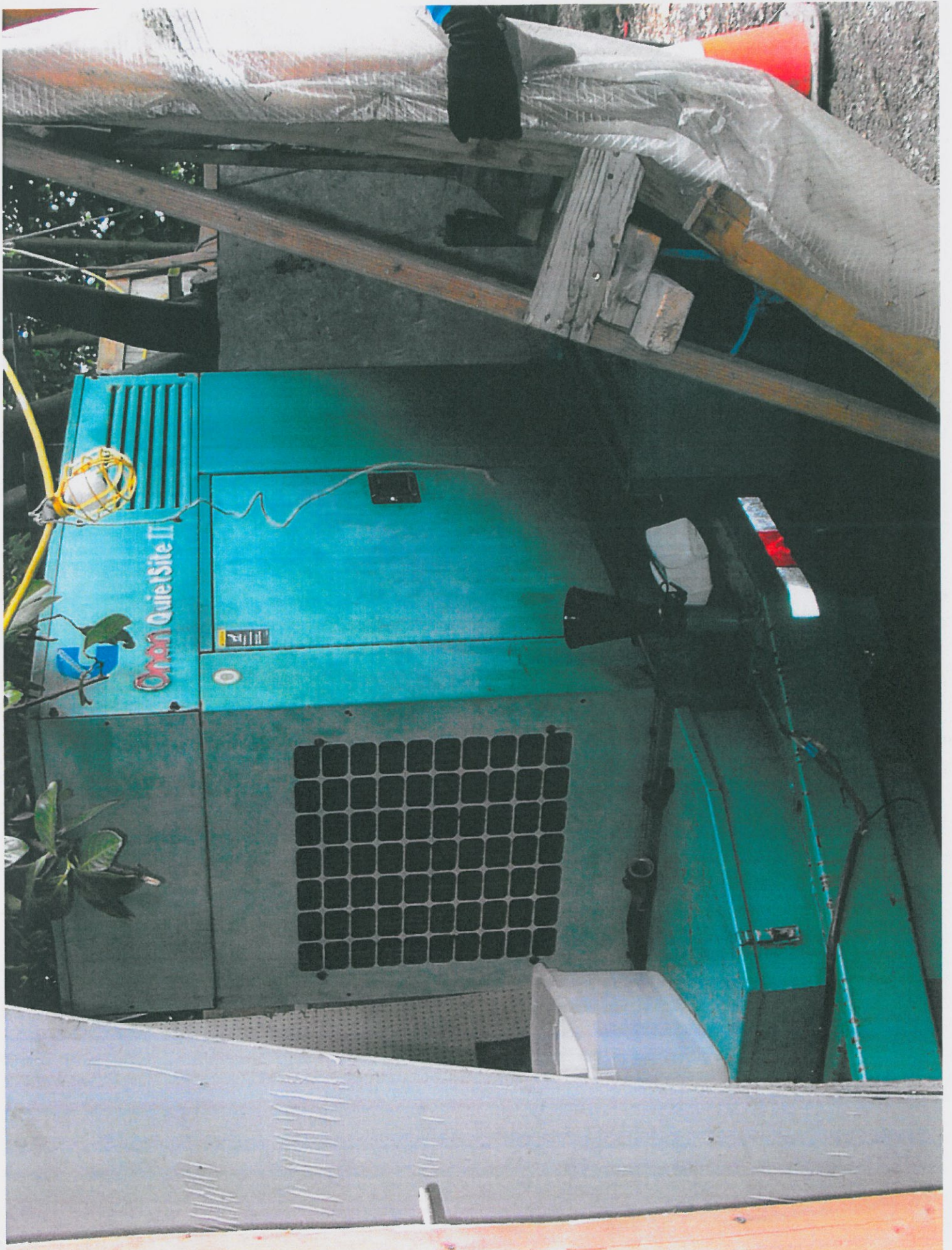

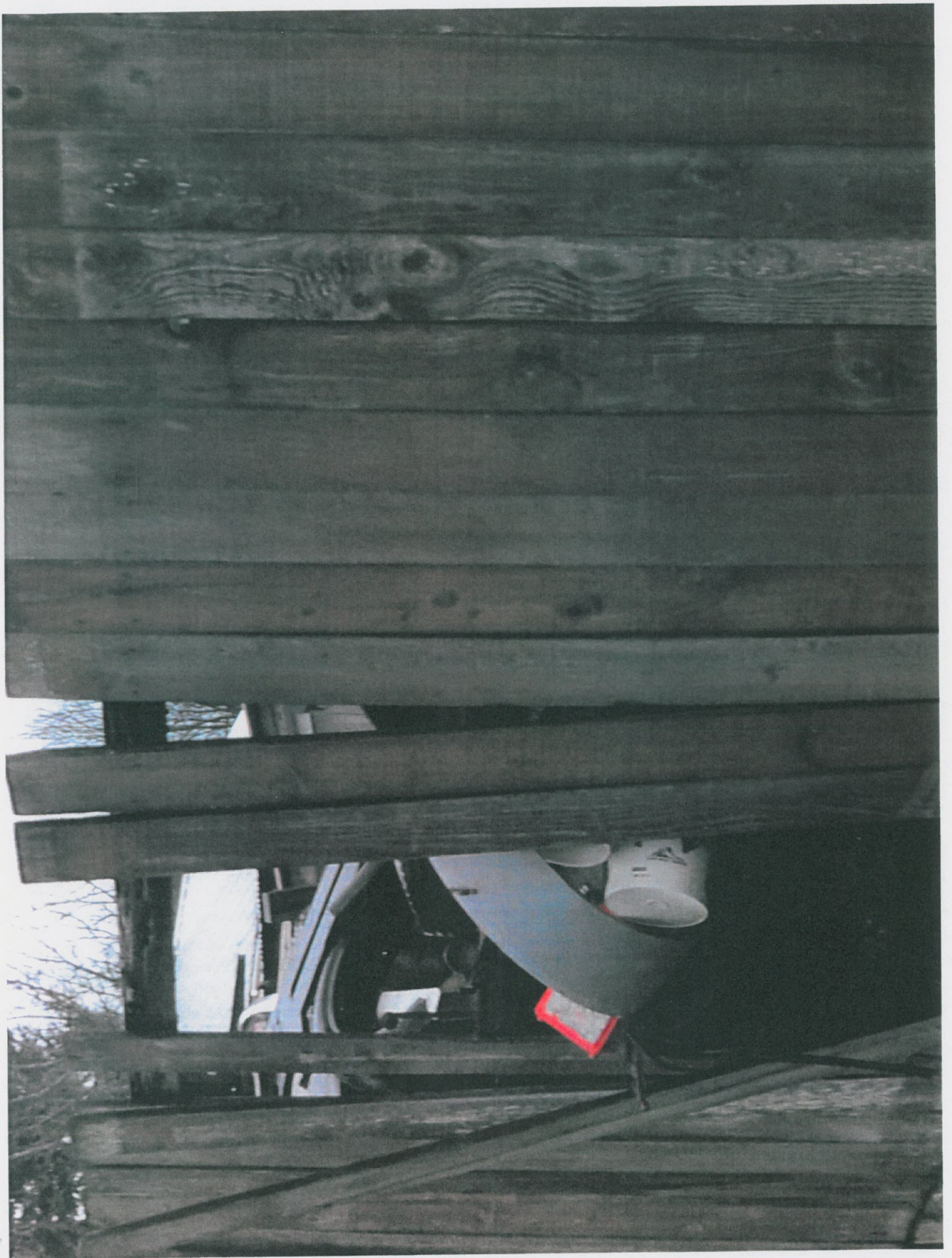

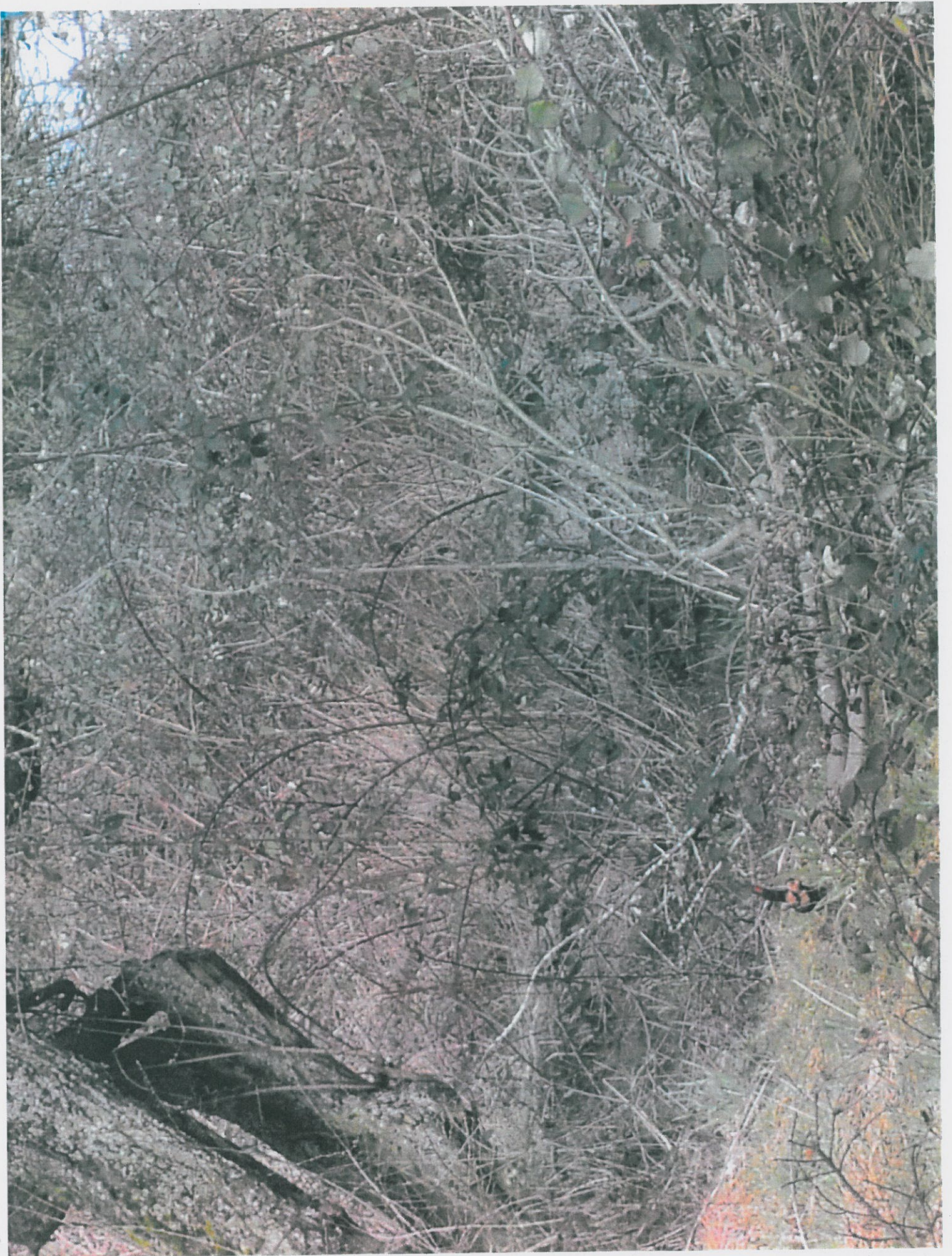

Conclusion

Question and Answers

ADDITIONAL RESOURCES

GOOD NEIGHBOR
BROCHURE

In an effort to maintain and enhance property values and to create a visually attractive community for our citizens, the active participation and cooperation of everyone in our community is essential.

Code Compliance

Barbara Canfield...
206-973.4756
bcanfield@ci.seatac.wa.us

King County Animal Control.....206.296.PETS
Barking or Loose Animals

King County Reporting Line.....206.205.0969
Vehicles in Public Streets

City of SeaTac Public Works.....206.973.4770
Illegal Dumping in the Streets
Recycle and Garbage Information.....206.973.4763

City of SeaTac Community and Economic Development.....206.973.4750
Building Services Division—Construction and Permit Information
Planning Division—Zoning and Land Use Questions
Engineering Review Division—Street, Drainage and Grading Information

City of SeaTac Human Services.....206.973.4815
Senior and Other Agency Information

City of SeaTac Municipal Court.....206.973.4610
Court Hearing and Ticket Information

City of SeaTac website.....www.ci.seatac.wa.us

City of SeaTac Municipal Codes.....www.codepublishing.com/wa/seatac

CODE COMPLIANCE



4800 South 188th Street
SeaTac, Washington 98188

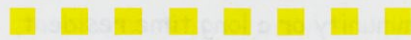

www.ci.seatac.wa.us

Tel: 206.973.4756
Fax: 206.973.4769

DEAR NEIGHBOR.....

In an effort to enhance City neighborhoods, the City's Code Compliance Officer help citizens protect the value and aesthetics of their property. The City's goal is to make your neighborhoods more attractive. The Code Compliance Officer will take complaints and respond accordingly.

We encourage all neighbors to work together to make positive changes for themselves, their community and in the process enhance their neighborhoods.



Whether you are new to the community or a long time resident, you may be interested in knowing what property maintenance codes are in effect for the City.

How Does the City Address Complaints ?

The Code Compliance Officer will contact a homeowner or tenant in person or by mail, asking that the violation(s) be corrected within an appropriate time frame.

If the violation(s) is not corrected within this time frame, the Code Compliance Officer will make a second attempt to contact the homeowner or tenant.

If the property remains in violation, the Code Compliance Officer will issue a Notice of Infraction or a Notice of Violation and Order to Abate, depending on the violation, and possibly assess fines.

If the violation(s) is still not corrected, the file will be turned over to the City's Legal Department for further action.

COMMON CODE VIOLATIONS

Parking Ordinance

The City has a residential parking ordinance which requires vehicles to be parked on an approved surface. Grass and dirt are not approved parking surfaces.

Tent/Canopy Structures

These types of structures are conditionally allowed in residential areas. The structures may be used only for vehicle protection and not for storage areas. There are size and placement restrictions. Please check with the Planning Department prior to installing your tent or canopy structure.

Fences

The rule of thumb for maximum fence height is four feet in the front yard and six feet in the side and rear yards. The front yard includes the first 20 feet of the front yard. The side yard starts after the 20 foot set back. Certain architectural features such as lattice allow the fence height to be increased.

Vehicle Storage and Automotive Parts

The outside storage of inoperable and wrecked vehicles is prohibited. Engines, drive-train parts, tires, or any other auto parts may not be stored outside. These types of vehicles and auto parts must be stored in a fully enclosed building so they are not visible from public or private property. Placing a tarp over an inoperable vehicle does not eliminate the violation.

Overgrown Vegetation

Grass or weeds over 12 inches in height and berry vines over three feet in height are not allowed (except vacant lots).



Trash

Trash or debris on private property includes items that are discarded, broken, indoor household items stored outside, shopping carts, and nuisances such as refrigerators and freezers,

Choosing a Pest Control Operator

Some rodent problems may be too extensive to control on your own and you may need to consider hiring a professional pest control service. When considering a professional pest control company for rodent control, be clear about what you want done and monitor their performance.

Pest control professionals can be found by looking in the phone book and online. Inquire about "integrated pest management" or "IPM" services. IPM methods often use less poison and employ other techniques to control pests. A pest control operator should inspect, monitor and make recommendations for excluding rodents. Interview companies and ask for references, including previous customers.

Ask to see their license. All pest control companies should be licensed and registered with the Washington State Department of Agriculture (WSDA). Washington pesticide law requires most businesses that commercially apply pesticides to be licensed as a Commercial Applicator. Additionally, in King County, Public Health permits Structural Pest Control Operators.

- WSDA Pesticide Licensing and Structural Pest Inspector licenses are available for look up online at <http://agr.wa.gov/PESTFERT/LicensingEd/>
- If you want to check that the business that you hire is licensed by Public Health - Seattle & King County view the list online at www.kingcounty.gov/healthservices/health/ehs/pco.aspx or call 206-205-4394.

How to Dispose of Dead Rats

- Wrap the dead rat in newspaper, or place in a plastic bag before putting in a tightly covered garbage can.
- Injured or sick rats **must be killed**, then wrapped and put in the garbage can.
- Do not touch dead rodents with bare hands.
- Use gloves if possible. If gloves are not available use the inside of a plastic bag or shovel.



Effective Rodent Control

For rodent traps and bait stations to be effective remove all food sources.

- Don't leave pet food or bird seed outside.
- Don't put food scraps in open home compost bins. Use a covered bin such as a green cone.
- Secure all garbage in a can with a lid.
- Store pet food and other foods that may attract rats in rodent proof containers.

Public Health 
Seattle & King County

Environmental Health Services
401 5th Ave, Suite 1100
Seattle, WA 98104

206-205-4394

www.kingcounty.gov/health/rats

Available in Alternate Formats

September 2009

RODENT CONTROL

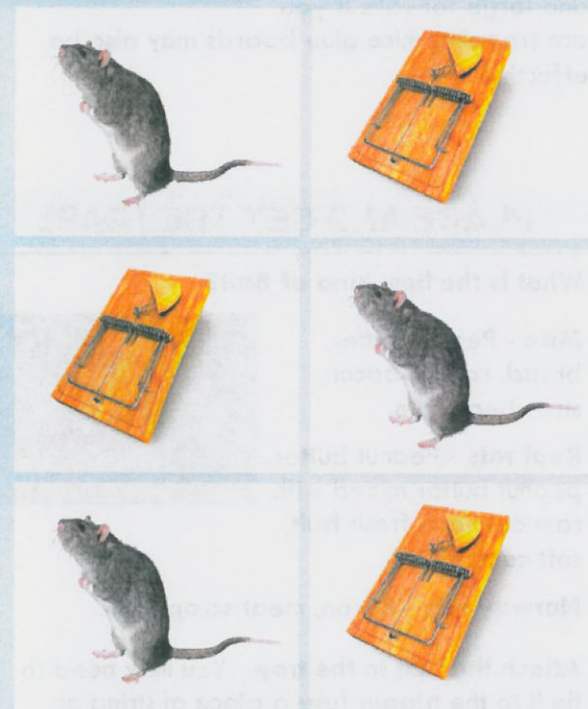

How to use rodent traps and bait stations

How to Use a Rat Trap

BAIT IT!

To catch a rat use a rat trap. The best trap is the simple cheap wooden "snap trap". They come in two sizes small for mice and large for rats. If you are trapping mice glue boards may also be effective.



PLACE AND SET THE TRAP!

What is the best kind of Bait?

Mice - Peanut butter, bread, raisins, bacon, strawberry jam.

Roof rats - Peanut butter, peanut butter mixed with raw oatmeal, fresh fruit, soft candies.

Norway rats - Bacon, meat scraps, fish.

Attach the bait to the trap. You may need to tie it to the trigger (use a piece of string or yarn) to prevent the rat from taking it. Don't put too much bait just use enough to attract the rodent.

Pre-bait the trap. Use an unset trap so that the rodent can become familiar with it and start feeding on the baited trap. Do this for two or three days and then set the trap.



RAT TRAPS WORK!

Use several traps at once, the more the better!

- Put them in places where you have seen rats or mice or near holes where rats may enter the building.
- Place the end of the trap containing the trigger facing the wall or known rodent runway.
- Set the trigger of the trap. You may need to adjust the sensitivity of the trigger. To do this read the instructions on the package.
- Traps can also be attached to pipes or studs with wire, nails or screws. Drill a hole through the wood part of the trap to prevent splitting when nailing or screwing to a surface.
- Continue setting the traps until you stop catching rats.



Make sure the trap is placed so that it is safe from children, pets or wild animals who could get hurt.

Using Bait Stations

If you are using poison to control rodents you must follow the directions on the label.

Poisons are not recommended for rat control inside buildings. Poisoned rats can die in hard to reach places and cause a bad smell. **Always secure poison in bait stations so that it is not available to children, pets or wild animals.**

When placing bait stations outside, consider all areas where bait should be placed such as wood piles, storage sheds and fence rows. They should be placed about 50 feet apart around buildings or along landscaped areas surrounding buildings.

Secure poison bait blocks on rods inside of the bait box. This prevents rats from carrying bait outside the box and dropping the poison on the ground. Place the bait station so that it will not become disturbed and overturned.

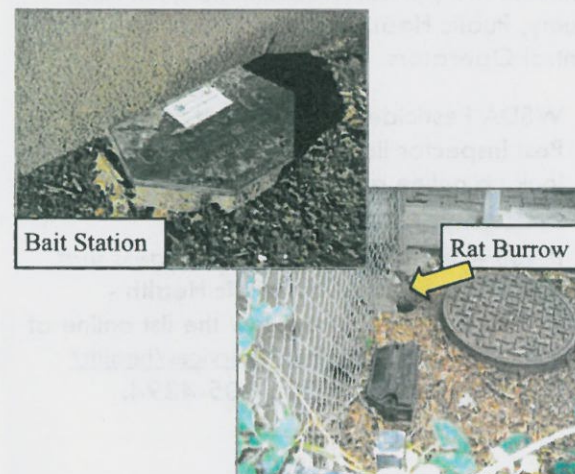

Nuisance Birds

In addition to attracting rats, overfeeding birds can also attract nuisance birds such as pigeons, crows, seagulls, and starlings. These birds are scavengers and frequently return to places where there is a reliable food source.

Nuisances created by birds include:

- **Feces accumulation.** Bird feces are acidic and can damage property and vehicles. Build up of bird feces is smelly, slippery and unappealing to look at. Bird feces can also carry diseases.
- **Some birds are bad neighbors.** They can spread trash and feathers and their feces can cover lawns, roofs, cars and lawn furniture. Large flocks of birds create noise nuisances.
- **A perceived overall lower quality of life.** Homes and neighborhoods become less enjoyable when there are large populations of nuisance birds.



Hundreds of pigeons on this roof are flocking to a neighborhood bird feeder. Neighbors in this community suffer from property damage caused by the birds and rats as well as noise and odor nuisances.



Take Responsibility
Be a Good Neighbor

When feeding wild birds please do so with care and consideration of your neighbors. Feed birds in such a way that does not create nuisance or rat problems in your neighborhood. In King County it is the responsibility of property owners to prevent conditions on their property that provide a home or food source for rats.

RESOURCES

Rat problems

Public Health—Seattle & King County
www.kingcounty.gov/health/rats

Report rat problems to Public Health
206-205-4394

King County rodent regulations
www.kingcounty.gov/healthservices/health/BOH

Pigeon nuisances

WA Dept of Wildlife: Living with Wildlife
Domestic Pigeons
<http://wdfw.wa.gov/wlm/living/pigeons.htm>

Crow nuisances

WA Dept of Wildlife: Living with Wildlife Crows
<http://wdfw.wa.gov/wlm/living/crows.htm>

Public Health 
Seattle & King County

Public Health—Seattle & King County
Environmental Health Services
Rodent Prevention Program
206-205-4394

Available in Alternate Formats

September 2009

Bird Feeders and Rats

What You Need to Know



Photo by Craig Nash www.pacificbirding.blogspot.com

“Bird feeders are good for providing food during times of scarcity, but food for wildlife should come primarily from native sources such as plants.”

The National Wildlife Federation

Feeding birds can attract rats!



Rats are frequently seen traveling through neighborhoods along fence tops and telephone lines in search of food. There are many different food sources commonly found in residential backyards, including improperly stored garbage, tree fruits, pet food, food waste in compost bins, grass seed, chicken feed and bird seed.

Bird feeders are very popular in King County and provide many hours of enjoyment for people who love to watch birds. However, if you feed birds expect to see increased rat numbers around your home. Bird seed easily spills out of feeders onto the ground, and it is impossible to remove all of it. Rats are good climbers and frequently access bird feeders hanging in trees. Rats are attracted to bird seed and will return often for this favorite food.



Bird seed is the food source for this young rat.

IMPORTANT!

If you have an active rat infestation, you must remove bird seed for trapping and poisoning efforts to be successful.

Tips to deter rats from your bird feeder

Bird feeder placement

- Place feeders four feet off of the ground and 8 feet out and away from any branches, fences, or other objects that rats may use to jump on to feeders.
- Use a “squirrel proof” feeder with a tray and a baffle that will prevent seed from spilling on the ground.



Seed selection and filling feeders

- Do not overfill the bird feeder with seed. Fill it with the minimum amount of seed that the birds might completely consume in a day.
- Do not leave any bird seed in feeders overnight. That is when rats are most active.
- Use a seed blend for the types of birds you are feeding. Seed blends that contain a lot of filler seeds and grains (millet, milo or sorghum) tend to end up on the ground where it attracts rats.



Storing bird seed

Rats easily chew through plastic containers. Always store bulk bird seed (and other pet foods) in a metal container to eliminate rodent access.



Sick birds at the feeder

Birds that feed in large groups are particularly susceptible to a number of diseases. Crowded bird feeders can stress birds and spread disease.

Diseases spread at bird feeders

- **Salmonellosis** is the most common bird feeder disease. Infected birds shed the salmonella bacteria in their droppings and via bird-to-bird contact.
- **Avian pox virus** is common in house finches. Infected birds may have wart-like growths on their legs, face, or feet. The virus is spread by direct contact with infected birds, ingestion of food and water contaminated by sick bird or contact with contaminated surfaces like dirty bird feeders and bird baths.
- **Aspergillus fungus** (mold) grows on damp feed and in debris under bird feeders. Birds inhale the fungal spores and the fungus spreads to their lungs and air sacs.
- **Trichomoniasis** is a disease caused by a parasite that causes sores in birds mouths and throats and can be fatal.

Preventing disease at bird feeders

- **Give birds space.** Spread feeders to avoid crowding and over-stressing birds.
- **Clean up waste.** Remove droppings and old seed. Mount feeders over a hard surface if possible to make cleaning easier.
- **Clean your bird feeder regularly.** Soak feeders in a bucket with 1 part bleach to 10 parts water for 10 minutes.
- **Use fresh food.** Don't use moldy or damp food.

How to Clean Up After Rodents

Hantavirus precaution!

Deer mice can shed hantavirus in their urine, which can be fatal to people. Allow buildings, sheds or homes that have been closed up to air out for 30 minutes before cleaning.

1. Wear latex or rubber gloves and a dust mask while cleaning.
2. Mix a solution of 1 cup bleach to 10 cups water or use a household disinfectant.
3. Don't vacuum, sweep or dry dust areas when cleaning. This disturbs dried rodent urine and feces that may contain harmful bacteria or viruses.
4. Wet down all contaminated areas, dead rodents, droppings and nesting areas with a disinfectant before cleaning. Allow the disinfectant to set for 10 minutes.
5. Disinfect counter tops, cabinets and drawers, floors and baseboards.
6. Steam clean carpets, rugs, and upholstered furniture.
7. Dispose of dead rodents and contaminated items by double bagging in plastic bags and placing in your garbage can outside.
8. Wash clothes and bedding with detergent and hot water. Set the dryer on high.
9. When you are done, disinfect or throw away the gloves you used. Wash your hands or shower with soap and hot water.

Making & Using a Disinfectant Solution

Mix a solution of 1 cup bleach to 10 cups of water.

Apply generously to the contaminated area and allow to set for 10 minutes before cleaning.



Take Responsibility Be a Good Neighbor

You can help prevent rodent problems in your neighborhood. In King County it is the responsibility of property owners to prevent conditions on their property that provide a home or food source for rats. You can do this by maintaining your property in a manner that is not attractive to rodents. After food sources and nesting places have been removed and rats have been eliminated, your property should be maintained so that the rats will not return.



RESOURCES

Report rat problems to Public Health.
Call 206-263-9566 or online at
www.kingcounty.gov/health/rats

King County rodent regulations:
Title 8 Zoonotic Disease Prevention
www.kingcounty.gov/health/BOH

Information about diseases from rodents
www.kingcounty.gov/health/zoonotics

Public Health 
Seattle & King County

Public Health—Seattle & King County
Environmental Health Services
Rodent Prevention Program
401 5th Ave. Suite 1100
Seattle, WA 98104
206-263-9566

Available in Alternate Formats

September 2009

RATS UNWANTED



Artwork by Leah Helms

Four Steps to
Prevent and Control
Rodent Infestations

A Guide for
Homeowners and Tenants

Rat Facts

Rats eat everything!

Rats climb, jump and swim. If a squirrel can climb it - a rat can climb it.

Rats gnaw through plastic, wood, soft metals, electrical wires (sometimes causing fires) and even cinderblock and brick.

Rats squeeze into tiny spaces, nest where it is dark and warm and can produce a litter of pups (babies) every 3 to 4 weeks!



Actual size hole
a rat can enter



Actual size hole
a mouse can enter

STEP 1

Take Away Their Food

Rodents will eat anything. To get rid of rats you must get rid of their food.



Common outdoor food sources include: bird food (all varieties), squirrel food, pet food, food waste in open home compost bins, fallen fruit from fruit trees, blackberries, garbage, grass seed and pet feces.

What do rats eat when they get inside?

The same foods we do. How we store foods in our own home is important to preventing rats. If rats and mice are getting into your home **store foods that are usually packaged in cardboard boxes or plastic bags in durable containers!**

STEP 2

Exterminate the Rodent Population

Trapping and poisoning are two effective ways to exterminate rodents. Some rodent problems may be too difficult to control on your own and you may need to hire a licensed pest control operator. You can find them in the yellow pages of the telephone directory under "Pest Control Services"

Trapping

Trapping is the preferred method of killing rats indoors. Wooden snap traps are inexpensive and effective. Peanut butter usually works as a bait. Set the trap and place it in an area with the most rodent activity. It should be placed about 3 inches from a wall. The trigger should face the wall. The traps may be placed in a box with openings on both ends to protect children and pets.



Poisoning

Poisoned rodents may die in floors and walls causing an odor. Poisons are not recommended for use inside homes or buildings. Rat poison for use outdoors is available from many hardware stores and can also be purchased from some professional pest control services or a store that specializes in pest control products.

Rat poison should always be used in secured bait station to keep it away from children and pets. Only use it according to the directions on the label.



Bait station or "Bait box"

STEP 3

Keep Rodents Out of Your Yard

Don't make your yard a nesting zone for rodents. Don't provide them with a place to live and raise their young.

Rats will nest in:

- Outdoor piles of garbage and junk
- Under wood piles or lumber. Stack wood piles 18 inches off the ground
- Under blackberry bushes, shrubs, vines and in tall grasses that are not trimmed or cut back
- In cars, appliances, furniture and carpet that has been put outside and is no longer being used
- In holes under buildings



STEP 4

Keep Rodents Out of Your Home

Small openings in homes, buildings or sheds must be sealed to prevent rodents from entering.

- Check for openings where pipes or wires enter the building, under eaves, and around foundations, doors and windows.
- Use cement, ¼ inch hardware cloth, wire mesh or steel wool to seal openings.
- Crawl spaces and attics must be sealed to prevent rodent access.
- Rodents often enter through open doors, windows or through pet doors. Install kick plates to prevent access under doors.



Community Building Committee

Council Presentation Outline

April 2014

1. We've been meeting since last May
 - a. We meet typically the 4th Wednesday of every month.
2. There are 7 of us with 2 alternates
3. Started with consensus building among the committee members which resulted in:
 - A. Creating bylaws and a mission statement:
 - a. "Build stronger relationships among communities and with the City of SeaTac to enhance a safe, healthy, place for all to thrive."
4. In order to grasp the demographics of SeaTac and the adjoining communities we asked various service groups to come speak to us:
 - a. City Council Members-To get an idea of their motivation for establishing the CBC and their expectations.
 - i. Received a list of items that the Committee is charged with. From that the Committee created a list of action items. (show information)
 - b. Human Services Coordinator Colleen Brandt-Schluter- Spoke of the demographics and needs of our citizens that are lower on the socioeconomic ladder.
 - c. Community Services Officer- Mechee Burnett
 - i. Spoke about her role in the City and mentioned several needs the City has and also her concerns about the youth population.
 - d. Lutheran Community Services-Zac Eskenazi, Emily Birchman-Spoke of refugee relocation as well as other services offered by the LCS.
 - i. Emily mentioned: They relocate 280 families per year from the Seattle office, most are relocated in Kent. Based largely on lower cost of housing and existing ethnic population. Refugees receive government funding assistance for 90 days.
 - ii. Zac mentioned: Besides healthcare, the Lutheran Family Resource Center services also include such classes as parent education and English as a second language.
 - e. Police Chief- Lisa Mulligan-Spoke of various crime rates in the different sections of the City.

- i. The City is divided into 4 areas L1-L4. The crime statistics for each area indicate there is no significant differences in crime among the 4 areas. (show information)
5. Our next exercise is to participate in existing City and community meetings and events.
 - a. Several of us will be volunteering for the “Back to School” program.
6. Future goal of creating a list of best practices of other jurisdictions along with our own ideas and coming back to Council in (December?) with list of recommendations.